

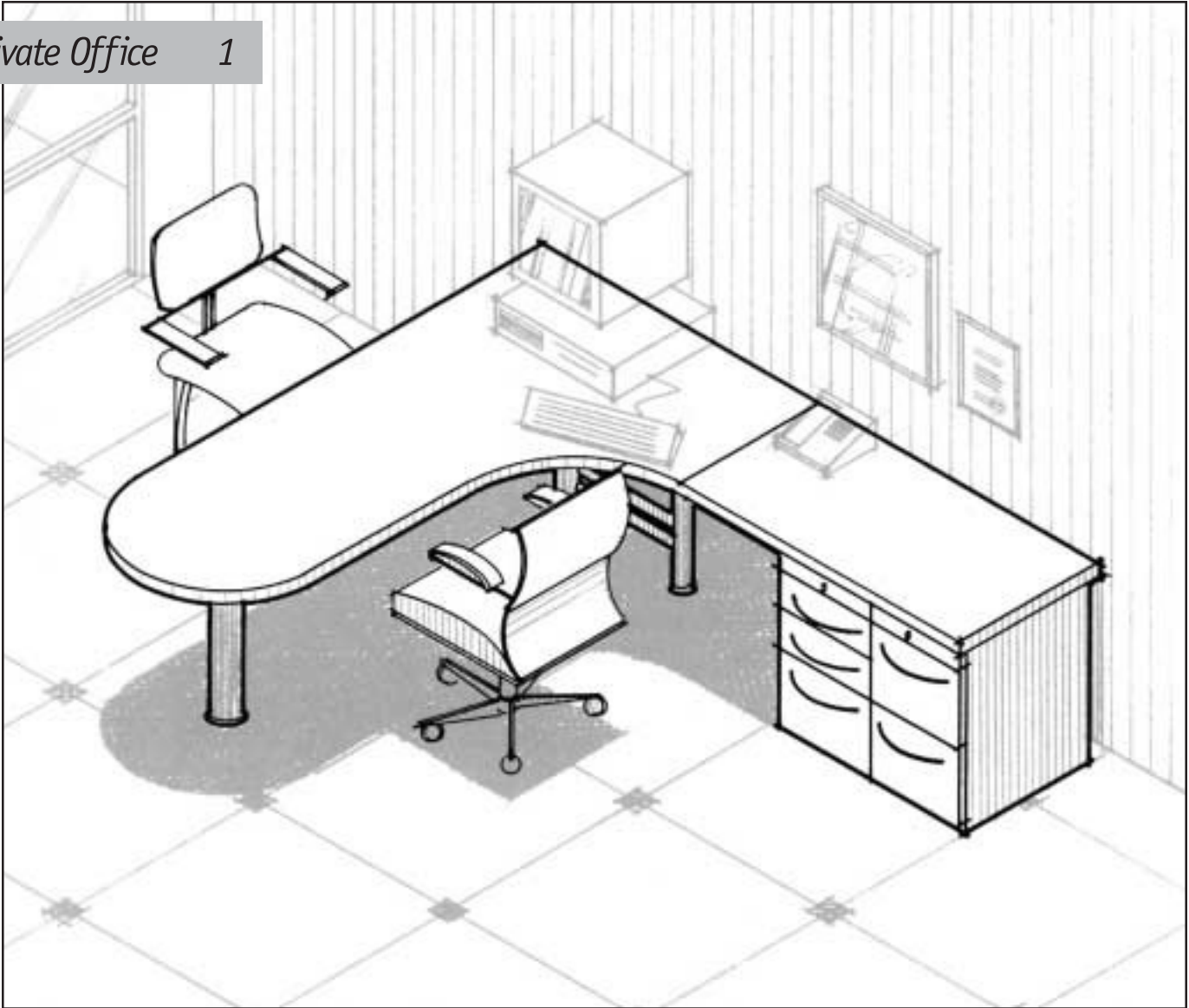

CounterPoint by HLF  
A Worksurface-Based  
Office Furniture  
System

# Application Guide

## Private Office 1



CONFERENCE "L" WORKSTATION 90" X 96"

Item	Model No.	Description	Size	Qty.
1	C1RW4824	Rectangular Worksurface	48 x 24 x 1 $\frac{5}{8}$	1
2	C1CC9048L/24	Conference Corner, Left 24	90 x 48 x 1 $\frac{5}{8}$	1
3	C2BB22	Pedestal, B/B/F	15 $\frac{3}{4}$ x 21 $\frac{1}{2}$ x 27 $\frac{1}{2}$	1
4	C2FF22	Pedestal, F/F	15 $\frac{3}{4}$ x 21 $\frac{1}{2}$ x 27 $\frac{1}{2}$	1
5	C3DL2327	Double Support Leg	23 x 3 x 27 $\frac{1}{2}$	1
6	C3SL4D27	Support Leg	4" dia x 27 $\frac{1}{2}$	1

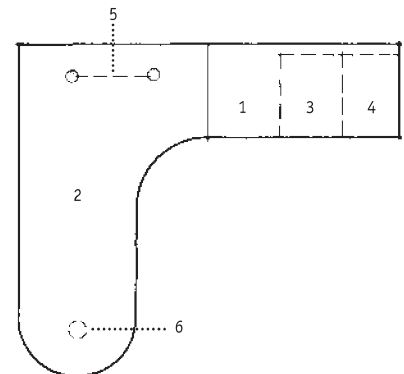
Scale:  $\frac{1}{4}$ " = 1 foot

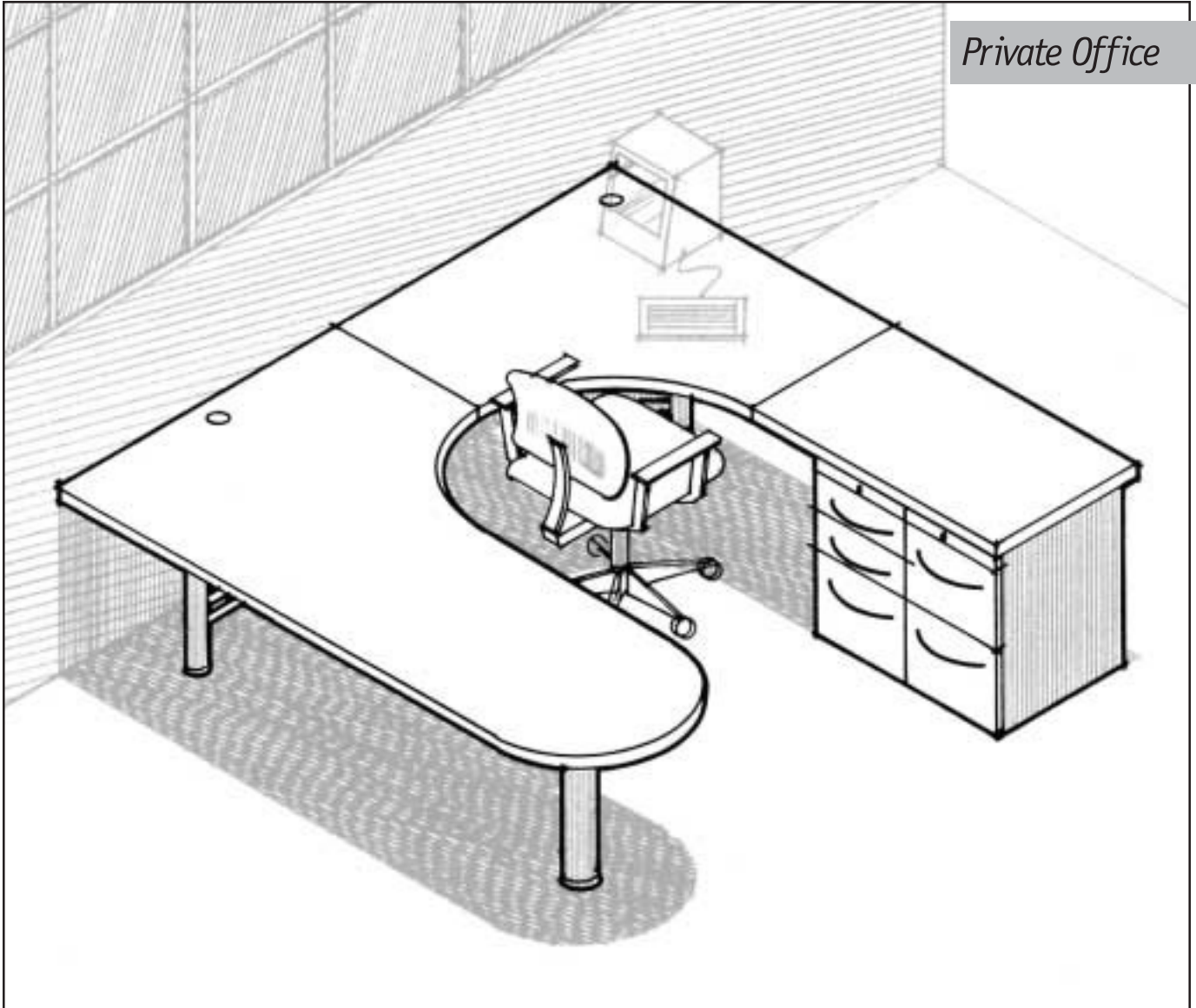
**CONFERENCE "U" WORKSTATION 90" X 96"**

Item	Model No.	Description	Size	Qty.
1	C1RW4224	Rectangular Worksurface	42 x 24 x 1 <sup>5</sup> / <sub>8</sub>	1
2	C1CI48/2424	Inside Radius Worksurface, 24L/24R	48 x 48 x 1 <sup>5</sup> / <sub>8</sub>	1
3	C1CC9048L/24	Conference Corner, Left 24	90 x 48 x 1 <sup>5</sup> / <sub>8</sub>	1
4	C2BB22	Pedestal, B/B/F	15 <sup>3</sup> / <sub>4</sub> x 21 <sup>1</sup> / <sub>2</sub> x 27 <sup>1</sup> / <sub>2</sub>	1
5	C2FF22	Pedestal, F/F	15 <sup>3</sup> / <sub>4</sub> x 21 <sup>1</sup> / <sub>2</sub> x 27 <sup>1</sup> / <sub>2</sub>	1
6	C3SL4D27	Support Leg	4" dia x 27 <sup>1</sup> / <sub>2</sub>	1
7	C3DL2327	Double Support Leg	23 x 3 x 27 <sup>1</sup> / <sub>2</sub>	2
8	C7TG50	Pass Through Grommet, Factory Installed	2 <sup>1</sup> / <sub>2</sub> " dia	1

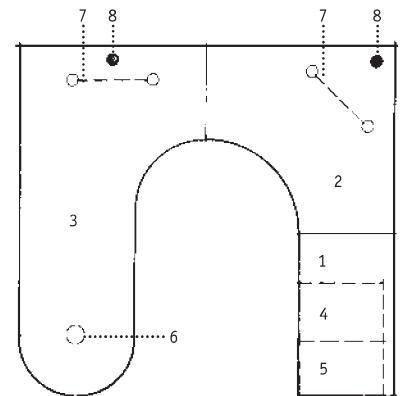

Scale: 1/4" = 1 foot

## Private Office 3

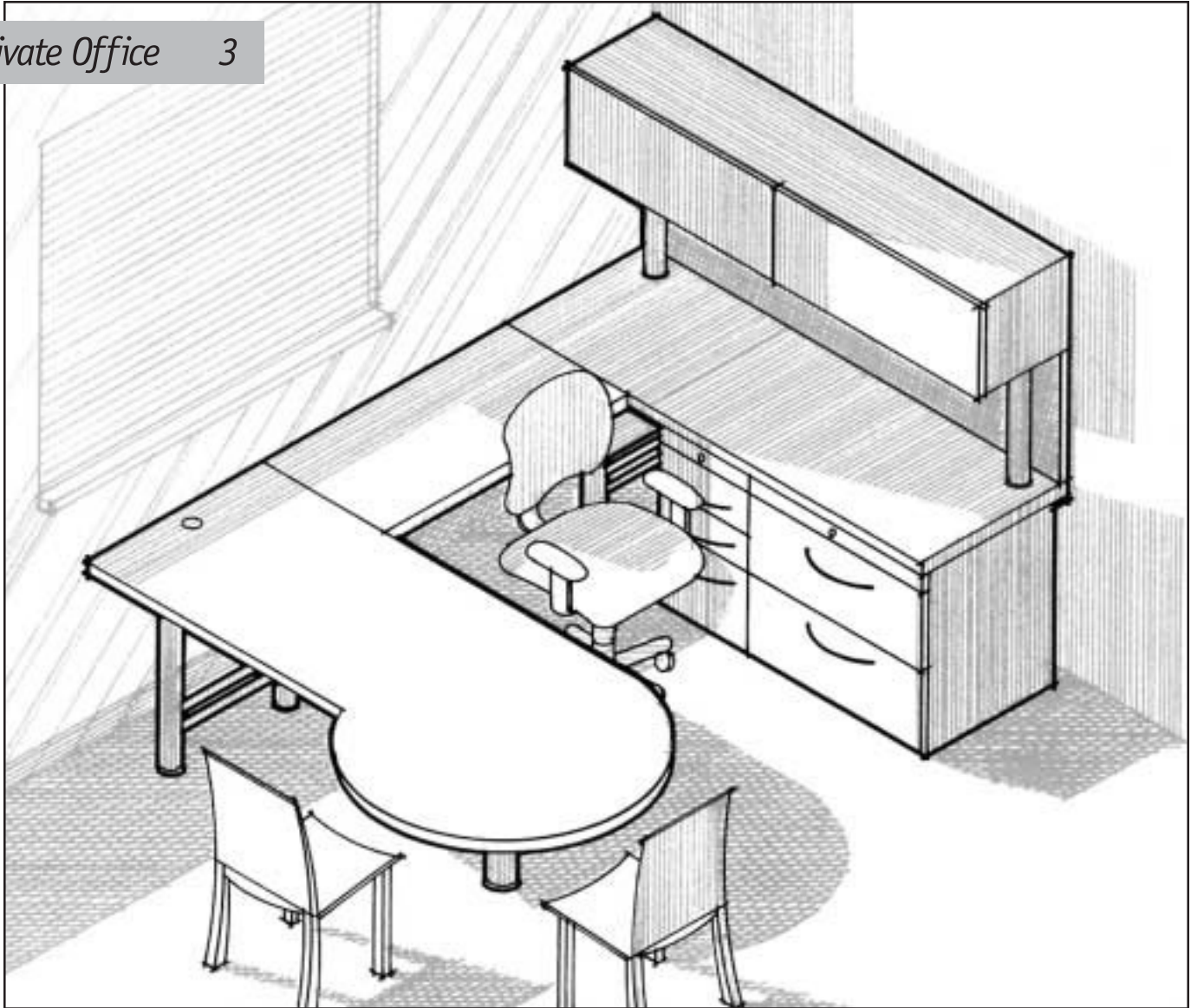
**"P" TOP WORKSTATION 84" X 104"**

Item	Model No.	Description	Size	Qty.
1	C1RW7220	Rectangular Worksurface	72 x 20 x 1 $\frac{5}{8}$	1
2	C1RW4220	Rectangular Worksurface	42 x 20 x 1 $\frac{5}{8}$	1
3	C1PT8442R	"P" Top, Right	84 x 42 x 1 $\frac{5}{8}$	1
4	C2BB18	Pedestal, B/B/F	15 $\frac{3}{4}$ x 18 x 27 $\frac{1}{2}$	1
5	C2LF302D	2 Drawer Lateral File	30 x 18 x 27 $\frac{1}{2}$	1
6	C3DL1727	Double Support Leg	16 $\frac{1}{4}$ x 3 x 27 $\frac{1}{2}$	1
7	C3DL2327	Double Support Leg	23 x 3 x 27 $\frac{1}{2}$	1
8	C3SL4D27	Support Leg	4" dia x 27 $\frac{1}{2}$	4
9	C4SF72	Upper Storage Cabinet, Flipper Door	72 x 15 x 16	1
10	C6TP7218	Tack Panel	72 x $\frac{3}{4}$ x 17 $\frac{1}{2}$	1
11	C7TG50	Pass Through Grommet, Factory Installed	2 $\frac{1}{2}$ " dia	1
12	C7TL48	Under Cabinet Task Light	48 x 5 x 2	1

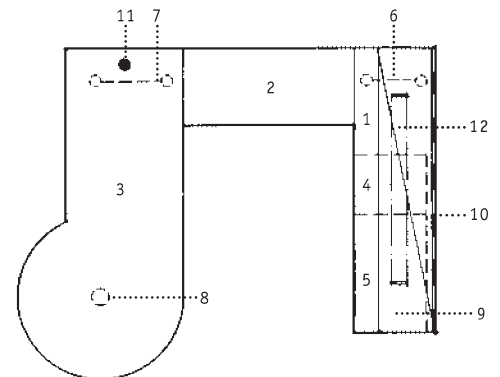
Scale:  $\frac{1}{4}$ " = 1 foot

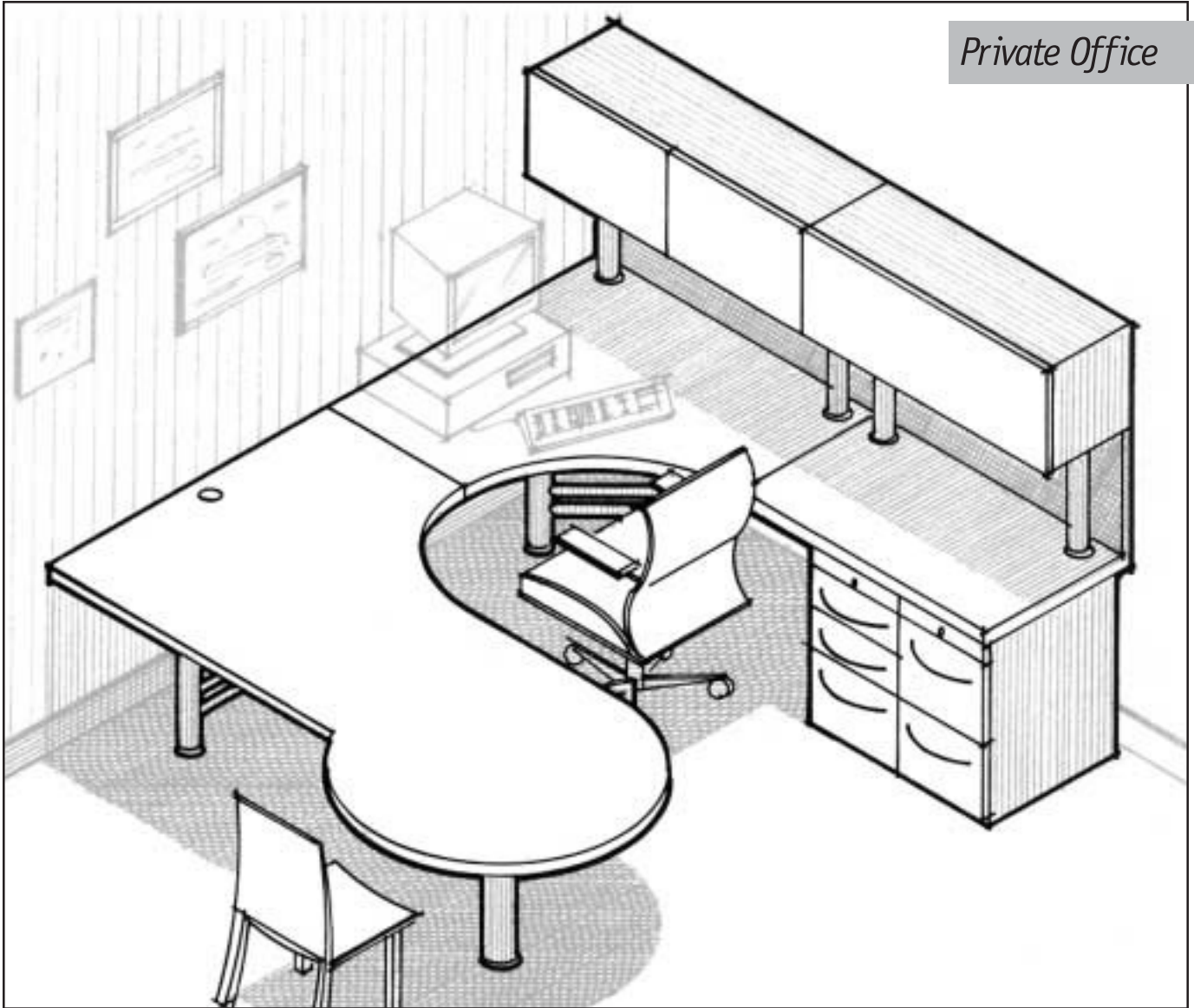
**PENINSULA WORKSTATION 90" X 108"**

Item	Model No.	Description	Size	Qty.
1	C1RW4224	Rectangular Worksurface	42 x 24 x 1 $\frac{5}{8}$	1
2	C1CI48/2424	Inside Radius Worksurface, 24L/24R	48 x 48 x 1 $\frac{5}{8}$	1
3	C1PW9060L/24	Peninsula Worksurface, 24" Runoff, LH	90 x 60 x 1 $\frac{5}{8}$	1
4	C2BB22	Pedestal, B/B/F	15 $\frac{3}{4}$ x 21 $\frac{1}{2}$ x 27 $\frac{1}{2}$	1
5	C2FF22	Pedestal, F/F	15 $\frac{3}{4}$ x 21 $\frac{1}{2}$ x 27 $\frac{1}{2}$	1
6	C3DL2327	Double Support Leg	23 x 3 x 27 $\frac{1}{2}$	2
7	C3SL4D27	Support Leg	4" dia x 27 $\frac{1}{2}$	1
8	C4SF48	Upper Storage Cabinet, Flipper Door	42 x 15 x 16	1
9	C4SF42	Upper Storage Cabinet, Flipper Door	42 x 15 x 16	1
10	C6TP4818	Tack Panel	48 x $\frac{3}{4}$ x 17 $\frac{1}{2}$	1
11	C6TP4218	Tack Panel	42 x $\frac{3}{4}$ x 17 $\frac{1}{2}$	1
12	C7TG50	Pass Through Grommet, Factory Installed	2 $\frac{1}{2}$ " dia	1
13	C7TL24	Under Cabinet Task Light	24 x 7 x 2	2

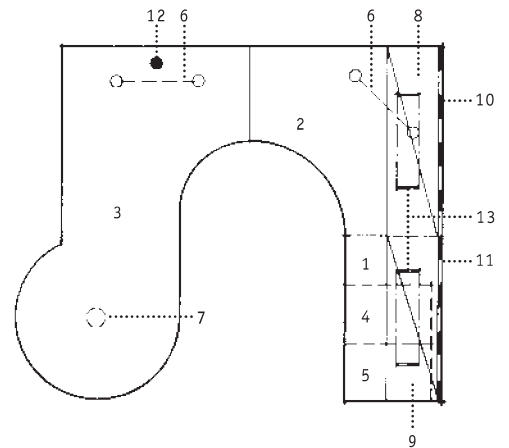
Scale:  $\frac{1}{4}$ " = 1 foot



## Private Office 5

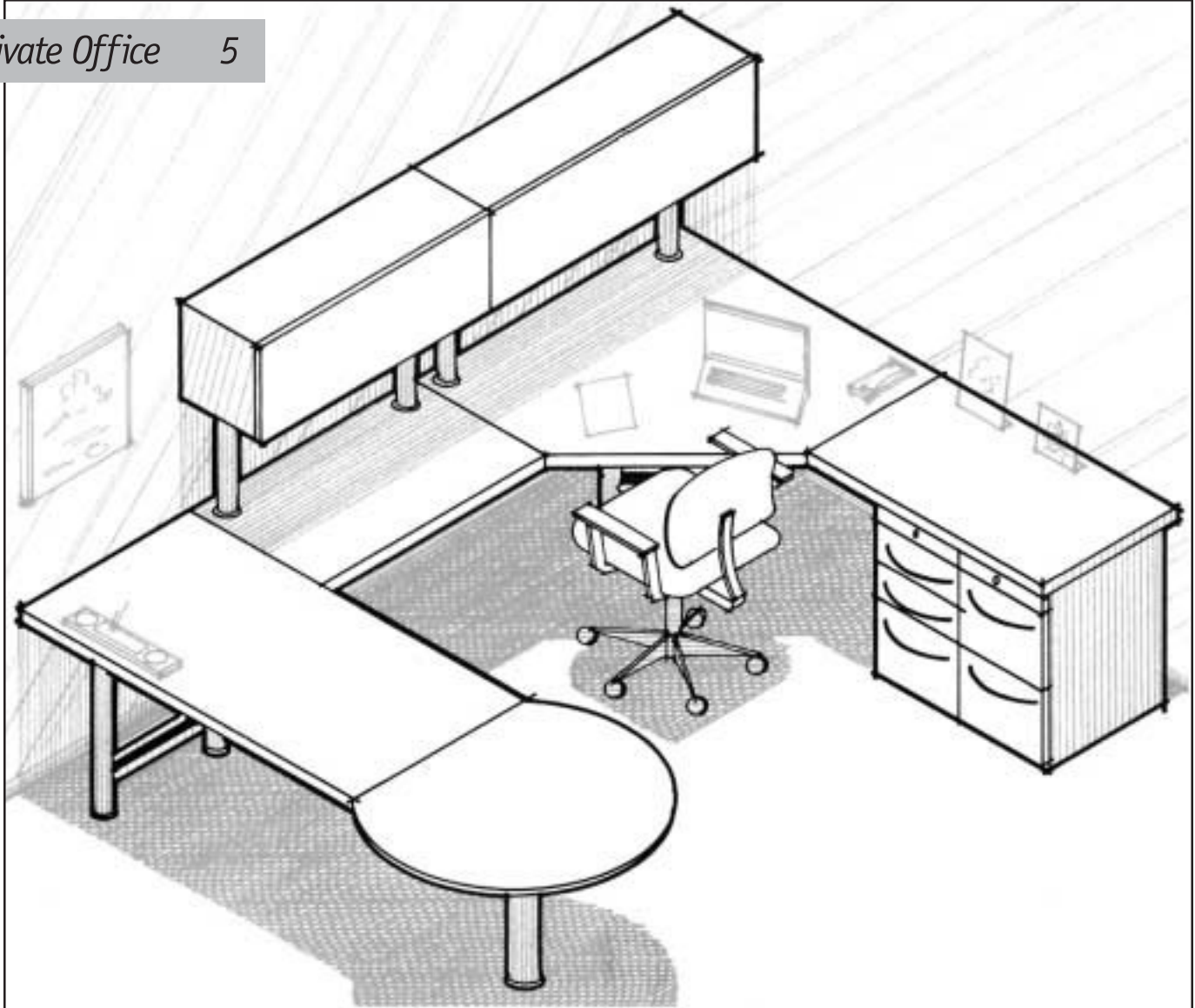

FLAT TIRE WORKSTATION 96" X 120"

Item	Model No.	Description	Size	Qty.
1	C1RW4224	Rectangular Worksurface	42 x 24 x 1 $\frac{5}{8}$	2
2	C1CW42/2424	Corner Worksurface, 24L/24R	42 x 42 x 1 $\frac{5}{8}$	1
3	C1RW6030	Rectangular Worksurface	60 x 30 x 1 $\frac{5}{8}$	1
4	C1FT42/30	Flat Tire Worksurface, 30" Runoff	42" dia x 1 $\frac{5}{8}$	1
5	C2FF22	Pedestal, F/F	15 $\frac{3}{4}$ x 21 $\frac{1}{2}$ x 27 $\frac{1}{2}$	1
6	C2BB22	Pedestal, B/B/F	15 $\frac{3}{4}$ x 21 $\frac{1}{2}$ x 27 $\frac{1}{2}$	1
7	C3SL4D27	Support Leg	4" dia x 27 $\frac{1}{2}$	1
8	C3SL3D27	Support Leg	3" dia x 27 $\frac{1}{2}$	1
9	C3DL2327	Double Support Leg	23 x 3 x 27 $\frac{1}{2}$	2
10	C4SF42	Upper Storage Cabinet, Flipper Door	42 x 15 x 16	2
11	C7TL24	Under Cabinet Task Light	24 x 5 x 2	2

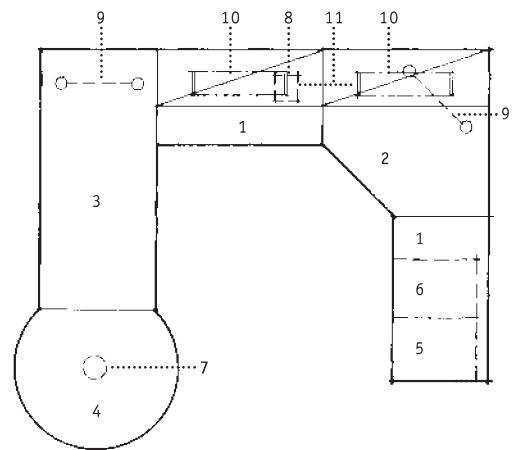
Scale:  $\frac{1}{4}$ " = 1 foot

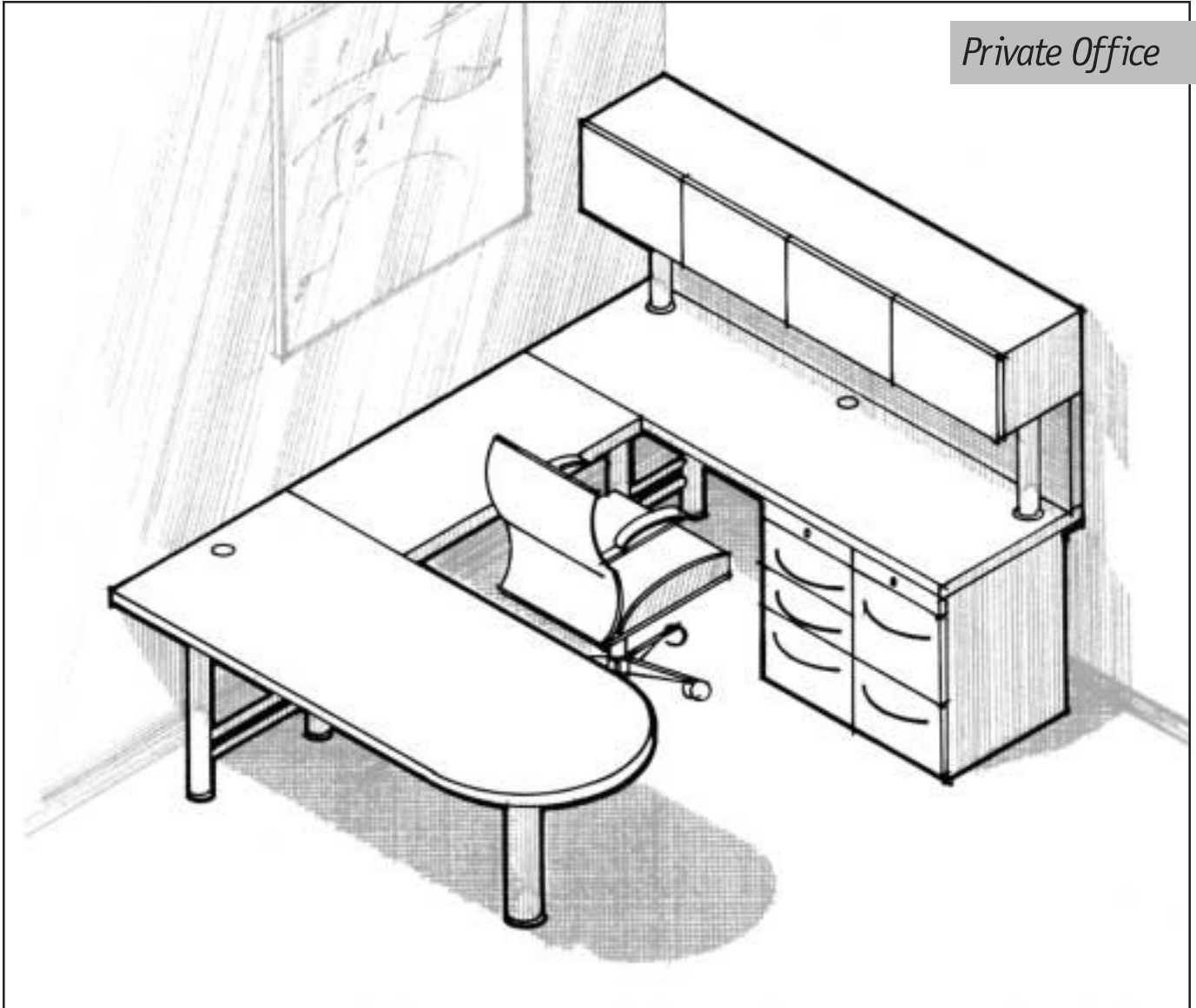
**BULLET WORKSTATION 72" X 92"**

Item	Model No.	Description	Size	Qty.
1	C1RW7220	Rectangular Worksurface	72 x 20 x 1 $\frac{5}{8}$	1
2	C1RW4220	Rectangular Worksurface	42 x 20 x 1 $\frac{5}{8}$	1
3	C1BW7230	Bullet Worksurface	72 x 30 x 1 $\frac{5}{8}$	1
4	C2BB18	Pedestal, B/B/F	15 $\frac{3}{4}$ x 18 x 27 $\frac{1}{2}$	1
5	C3DL1727	Pedestal, F/F	15 $\frac{3}{4}$ x 18 x 27 $\frac{1}{2}$	1
6	C3DL2327	Double Support Leg	16 $\frac{1}{4}$ x 3 x 27 $\frac{1}{2}$	1
7	C3DL1727	Double Support Leg	23 x 3 x 27 $\frac{1}{2}$	1
8	C3SL4D27	Support Leg	4" dia x 27 $\frac{1}{2}$	1
9	C4SH72	Under Storage Cabinet, Hinged Door	72 x 15 x 16	1
10	C6TP7218	Tack Panel	72 x $\frac{3}{4}$ x 17 $\frac{1}{2}$	1
11	C7TG50	Pass Through Grommet, Factory Installed	2 $\frac{1}{2}$ " dia	2
12	C7TL48	Under Cabinet Task Light	48 x 5 x 2	1

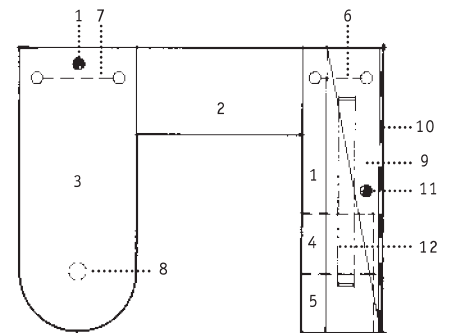
Scale:  $\frac{1}{4}$ " = 1 foot

## Private Office 7

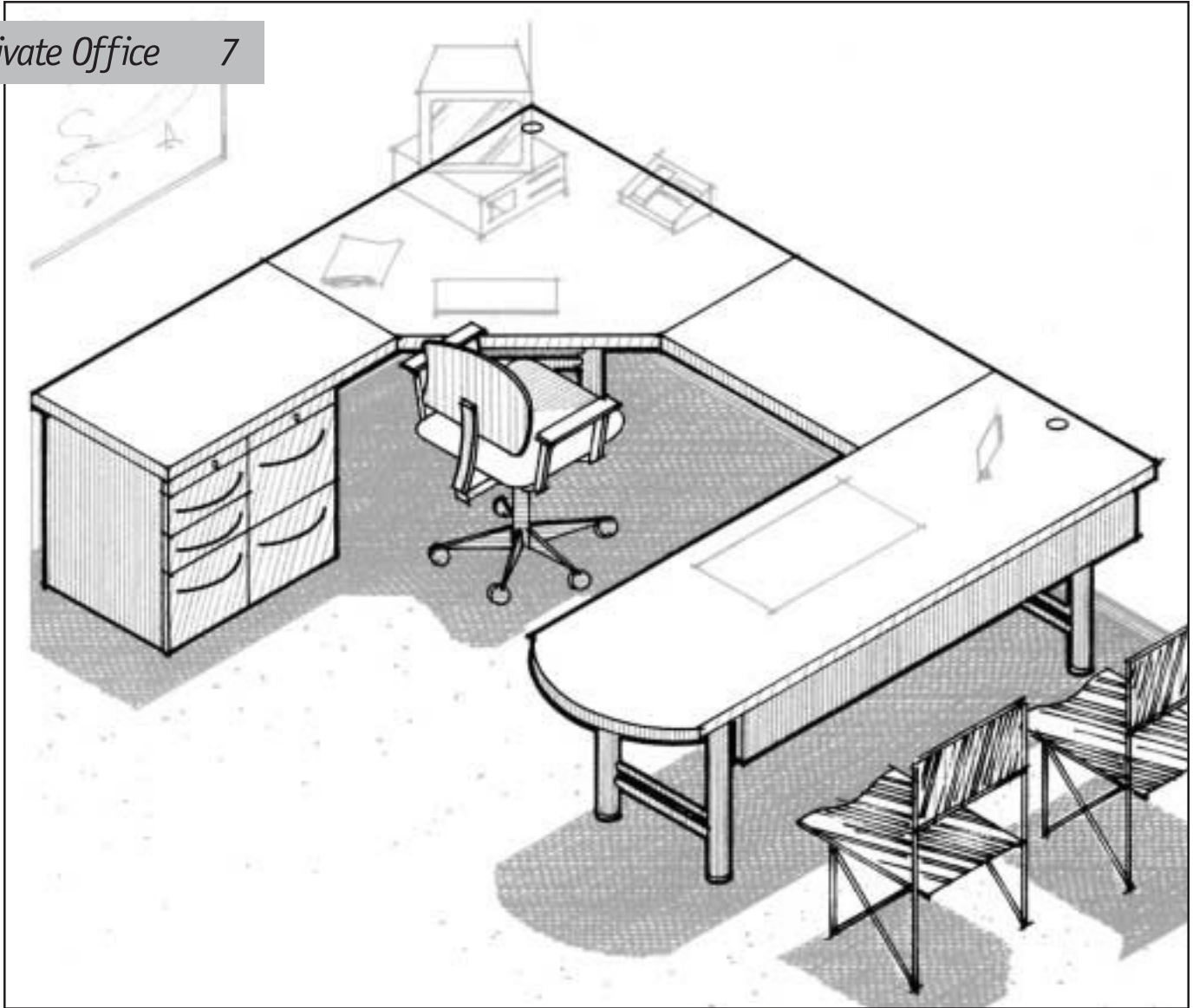
**BOW END WORKSTATION 84" X 108"**

Item	Model No.	Description	Size	Qty.
1	C1RW4224	Rectangular Worksurface	42 x 24 x 1 $\frac{5}{8}$	1
2	C1CW42/2424	Corner Worksurface, 24L/24R	42 x 42 x 1 $\frac{5}{8}$	1
3	C1RW3624	Rectangular Worksurface	36 x 24 x 1 $\frac{5}{8}$	1
4	C1BE8430	Bow End Worksurface	84 x 30 x 1 $\frac{5}{8}$	1
5	C2BB22	Pedestal, B/B/F	15 $\frac{3}{4}$ x 21 $\frac{1}{2}$ x 27 $\frac{1}{2}$	1
6	C2FF22	Pedestal, F/F	15 $\frac{3}{4}$ x 21 $\frac{1}{2}$ x 27 $\frac{1}{2}$	1
7	C3DL2327	Double Support Leg	23 x 3 x 27 $\frac{1}{2}$	3
8	C6MP7812	Modesty Panel	78 x 3 $\frac{3}{4}$ x 12	1
9	C7TG50	Pass Through Grommet, Factory Installed	2 $\frac{1}{2}$ " dia	2
10	C7KT20	Articulating Keyboard Tray	20 x 17 $\frac{1}{2}$ x 3 $\frac{1}{2}$	1

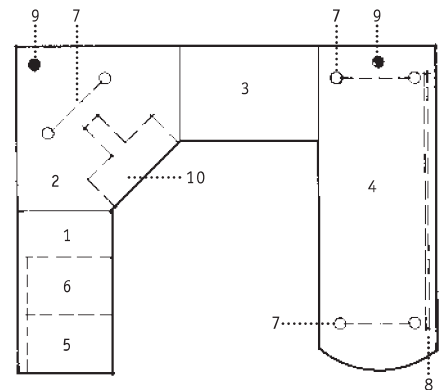
Scale:  $\frac{1}{4}$ " = 1 foot

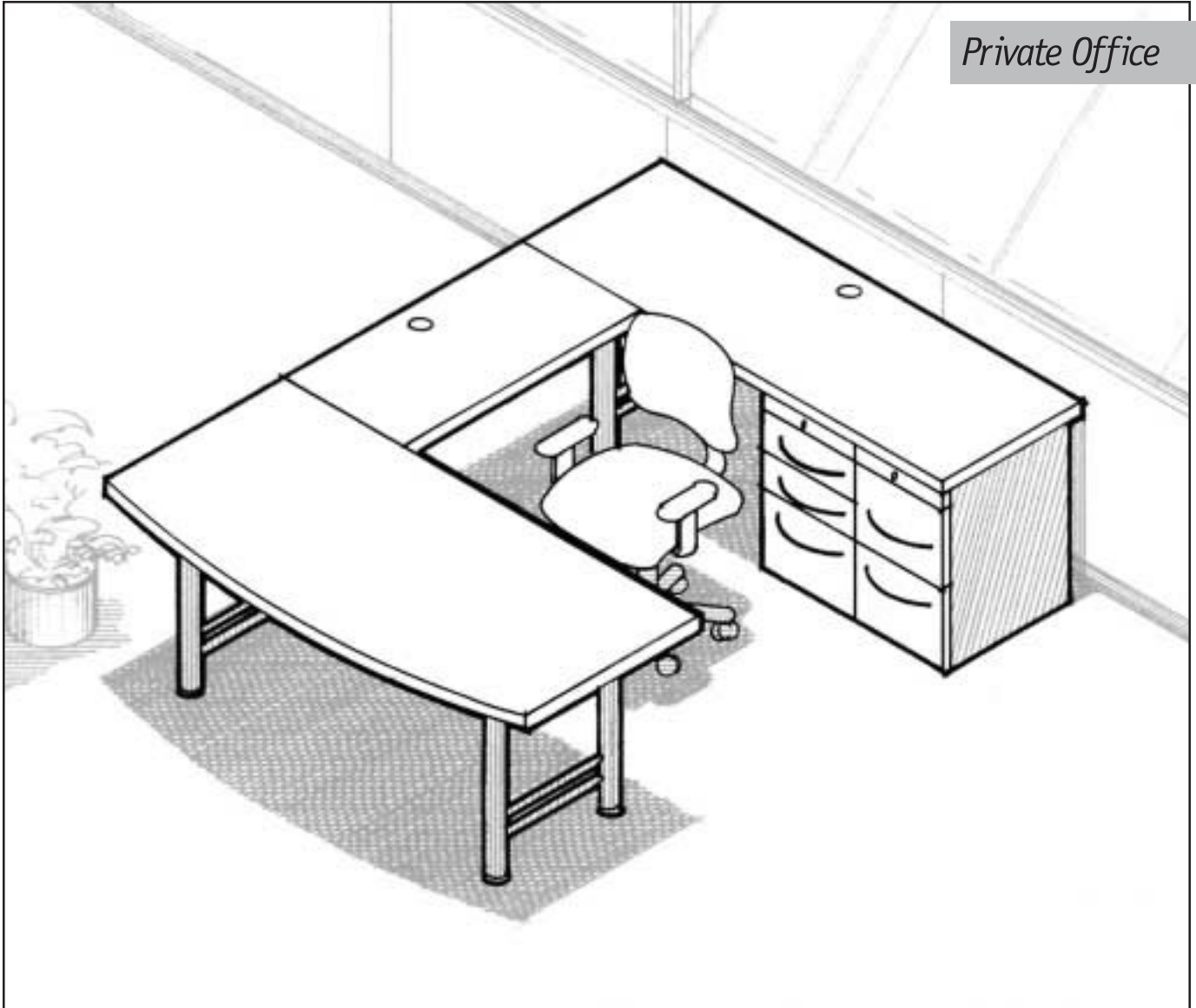

**BOW FRONT WORKSTATION 72" X 102"**

Item	Model No.	Description	Size	Qty.
1	C1RW7224	Rectangular Worksurface	72 x 24 x 1 <sup>5</sup> / <sub>8</sub>	1
2	C1RW4224	Rectangular Worksurface	42 x 24 x 1 <sup>5</sup> / <sub>8</sub>	1
3	C1BF7236	Bow Front Worksurface	72 x 36 x 1 <sup>5</sup> / <sub>8</sub>	1
4	C2BB22	Pedestal, B/B/F	15 <sup>3</sup> / <sub>4</sub> x 21 <sup>1</sup> / <sub>2</sub> x 27 <sup>1</sup> / <sub>2</sub>	1
5	C2FF22	Pedestal, F/F	15 <sup>3</sup> / <sub>4</sub> x 21 <sup>1</sup> / <sub>2</sub> x 27 <sup>1</sup> / <sub>2</sub>	1
6	C3DL2327	Double Support Leg	23 x 3 x 27 <sup>1</sup> / <sub>2</sub>	2
7	C3DL1727	Double Support Leg	16 <sup>1</sup> / <sub>4</sub> x 3 x 27 <sup>1</sup> / <sub>2</sub>	1
8	C7TG50	Pass Through Grommet, Factory Installed	2 <sup>1</sup> / <sub>2</sub> " dia	2

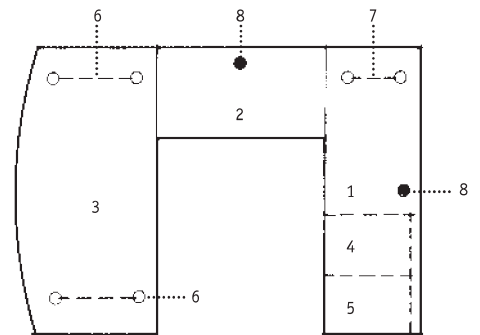

Scale: 1/4" = 1 foot

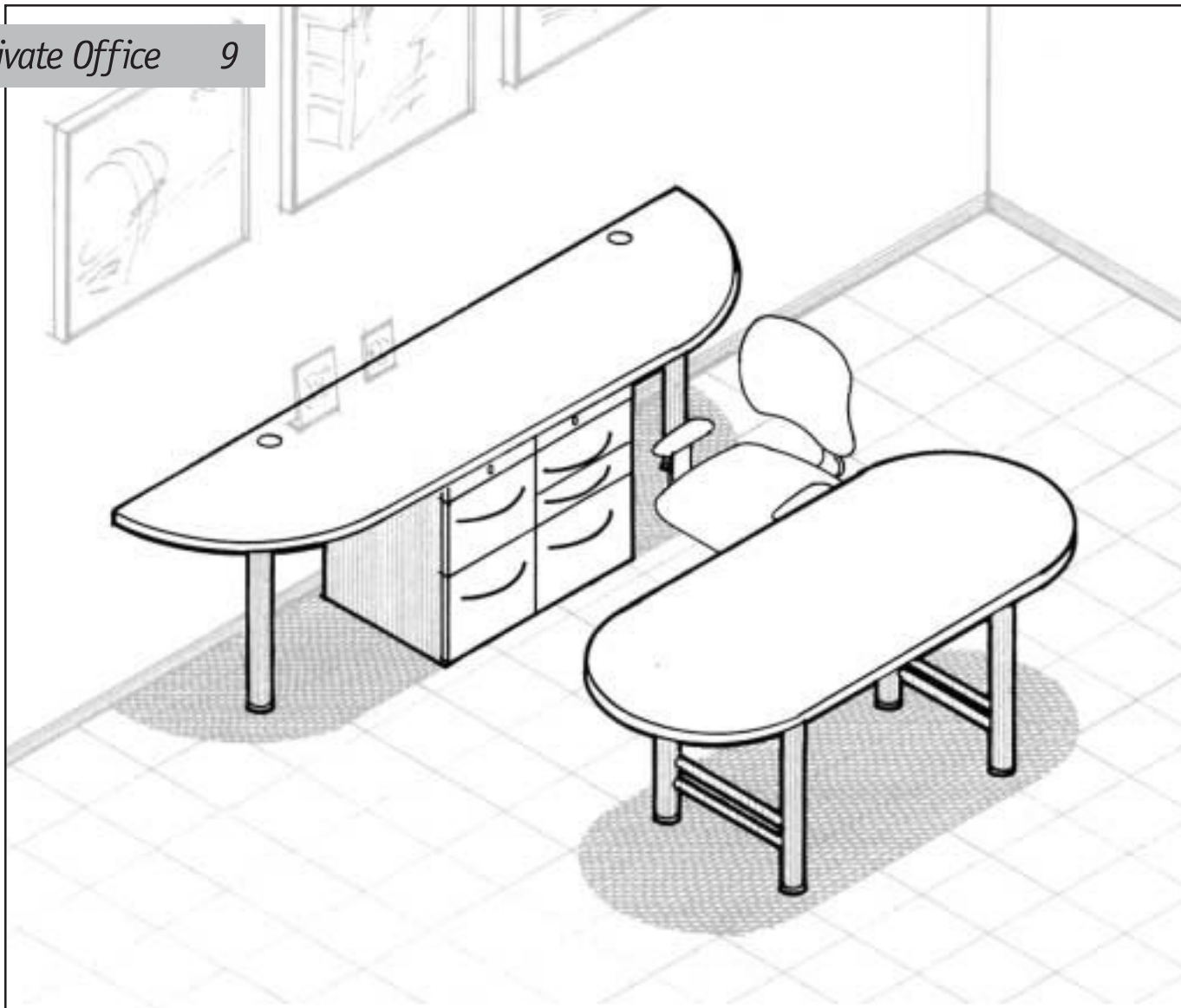
**RACETRACK WORKSTATION 96" X 96"**

Item	Model No.	Description	Size	Qty.
1	C1RT7230	Race Track Worksurface	72 x 30 x 1 $\frac{5}{8}$	1
2	C1DR9624	Double End Radius Worksurface	96 x 24 x 1 $\frac{5}{8}$	1
3	C2BB22	Pedestal, B/B/F	15 $\frac{3}{4}$ x 21 $\frac{1}{2}$ x 27 $\frac{1}{2}$	1
4	C2FF22	Pedestal, F/F	15 $\frac{3}{4}$ x 21 $\frac{1}{2}$ x 27 $\frac{1}{2}$	1
5	C3SL3D27	Support Leg	3" dia x 27 $\frac{1}{2}$	2
6	C3DL2327	Double Support Leg	23 x 3 x 27 $\frac{1}{2}$	2
7	C7TG50	Pass Through Grommet, Factory Installed	2 $\frac{1}{2}$ " dia	2

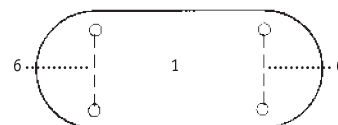
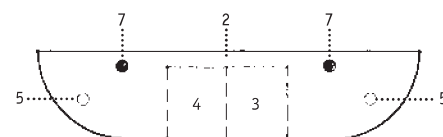
Scale:  $\frac{1}{4}" = 1$  foot

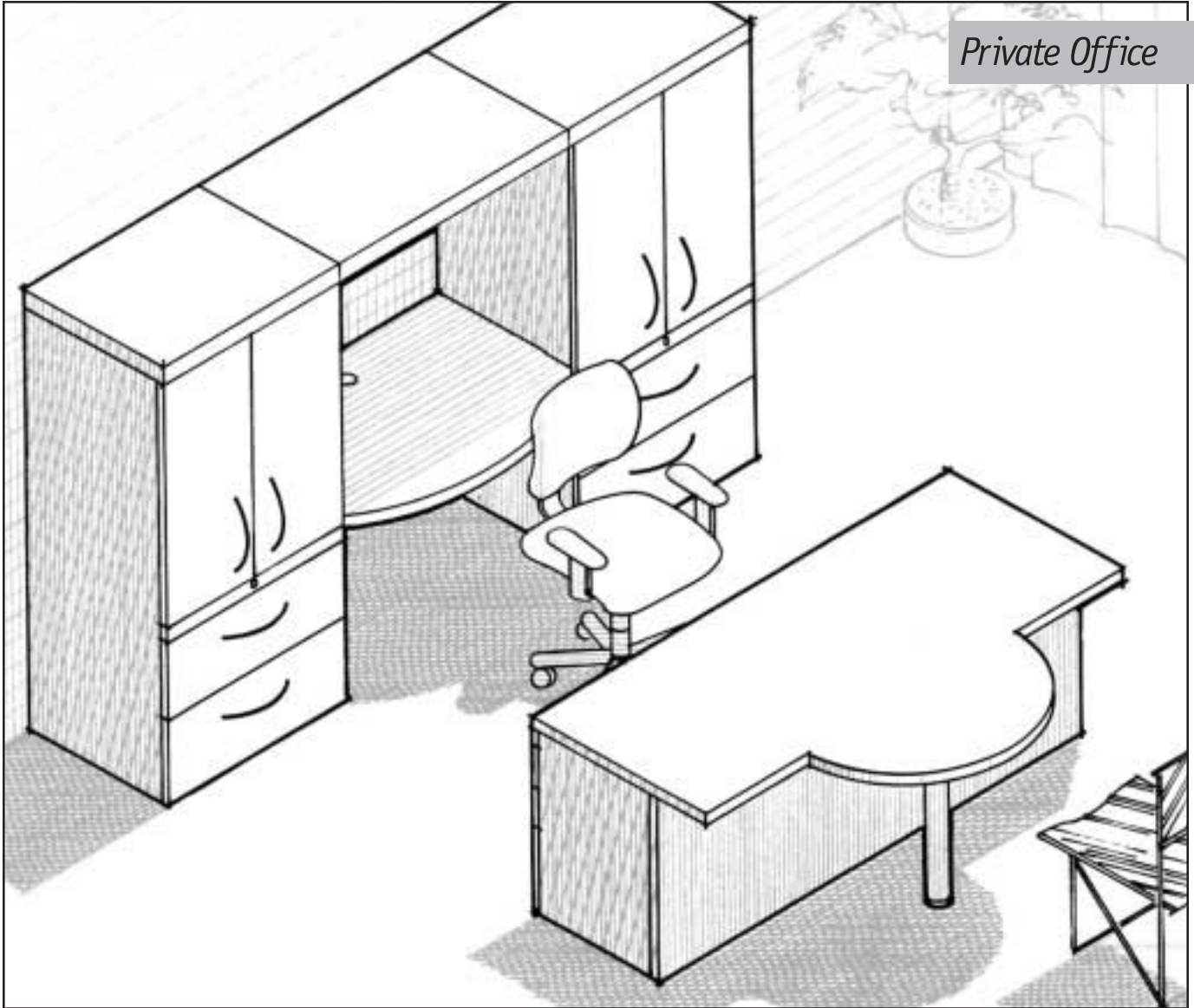
**WHITE HOUSE WORKSTATION 96" X 118"**

Item	Model No.	Description	Size	Qty.
1	C1WH7230	White House Worksurface	72 x 46 x 1 $\frac{5}{8}$	1
2	C1BF3630	Bow Front Worksurface	36 x 30 x 1 $\frac{5}{8}$	1
3	C2BB22	Pedestal, B/B/F	15 $\frac{3}{4}$ x 21 $\frac{1}{2}$ x 27 $\frac{1}{2}$	1
4	C2FF22	Pedestal, F/F	15 $\frac{3}{4}$ x 21 $\frac{1}{2}$ x 27 $\frac{1}{2}$	1
5	C3SL3D27	Support Leg	3" dia x 27 $\frac{1}{2}$	1
6	C5DL302463	Tower File, w/Doors	30 x 24 x 63	2
7	C5TT3624	Tower Top	36 x 24 x 3	1
8	C5TT3024	Tower Top	30 x 24 x 3	2
9	C6FM7226	Full Modesty Panel	72 x 1 $\frac{1}{2}$ x 26 $\frac{3}{8}$	1
10	C7TG50	Pass Through Grommet, Factory Installed	2 $\frac{1}{2}$ " dia	1

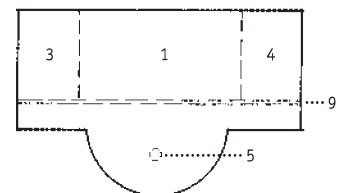
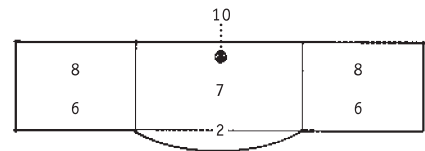

Scale: 1/4" = 1 foot

*Open Office*

1

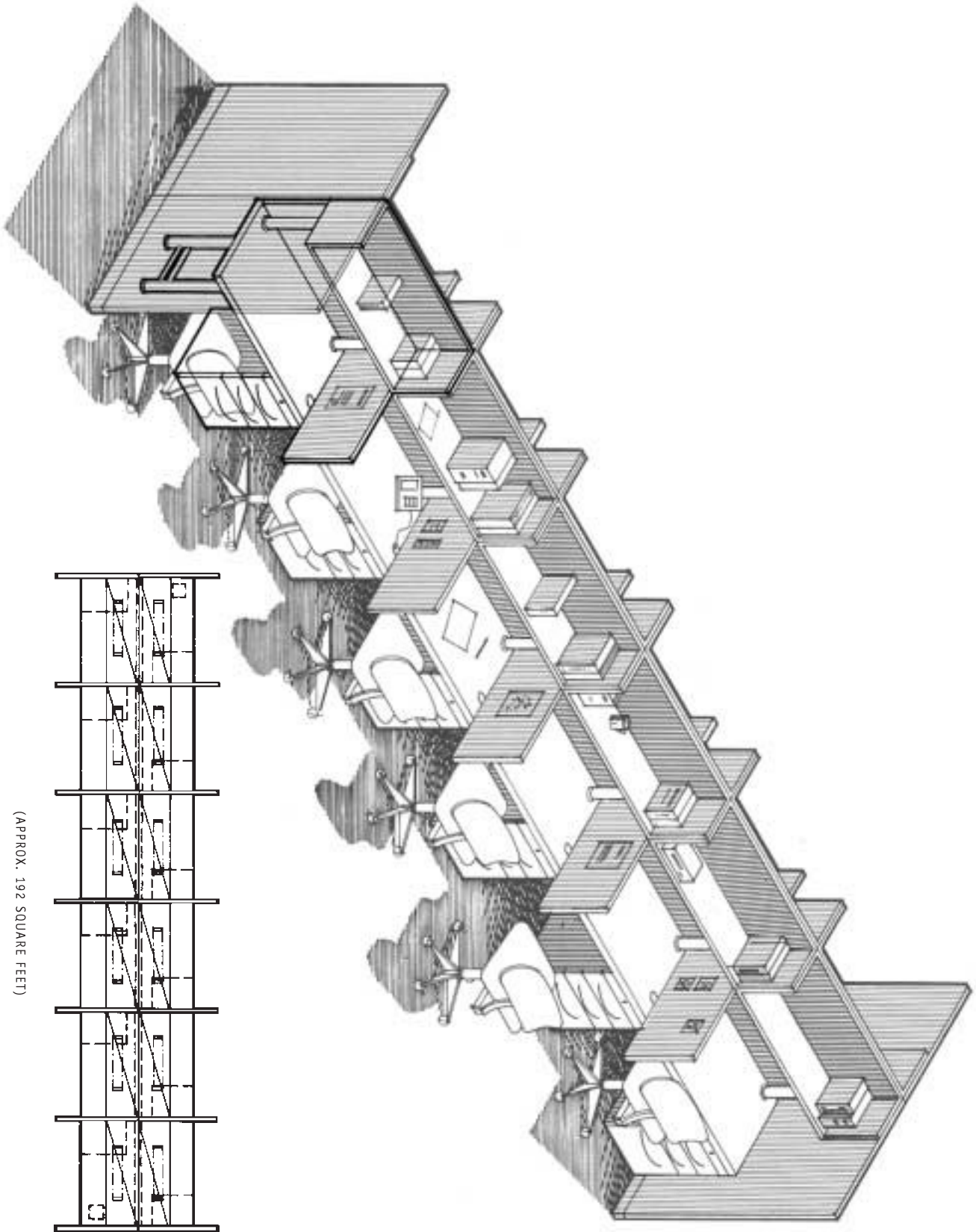

\$ LIST (PER STATION)



*Open Office*

2

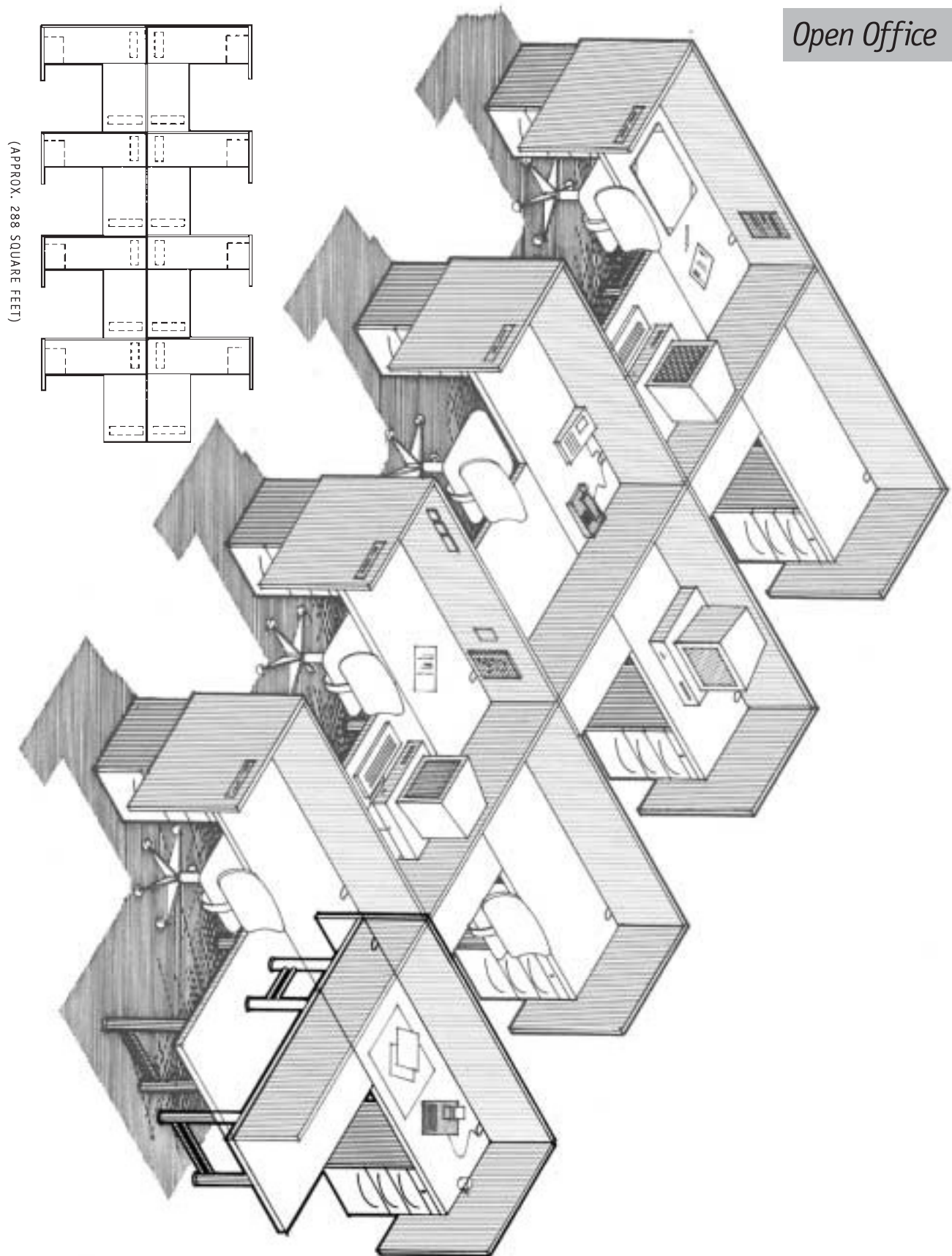

\$ LIST (PER STATION)



*Open Office*

3

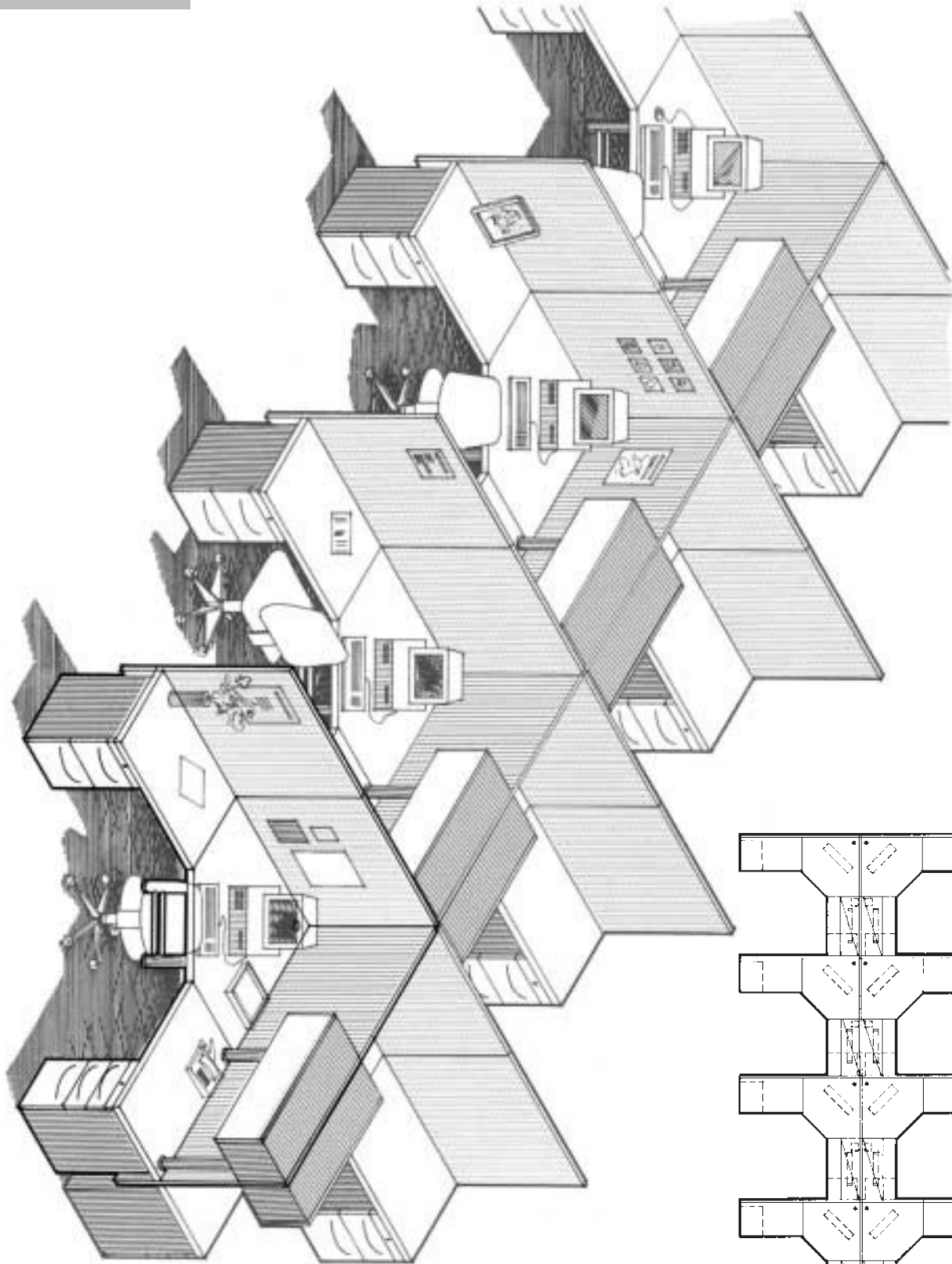

(APPROX. 392 SQUARE FEET)

\$ LIST (PER STATION)

(APPROX. 338 SQUARE FEET)

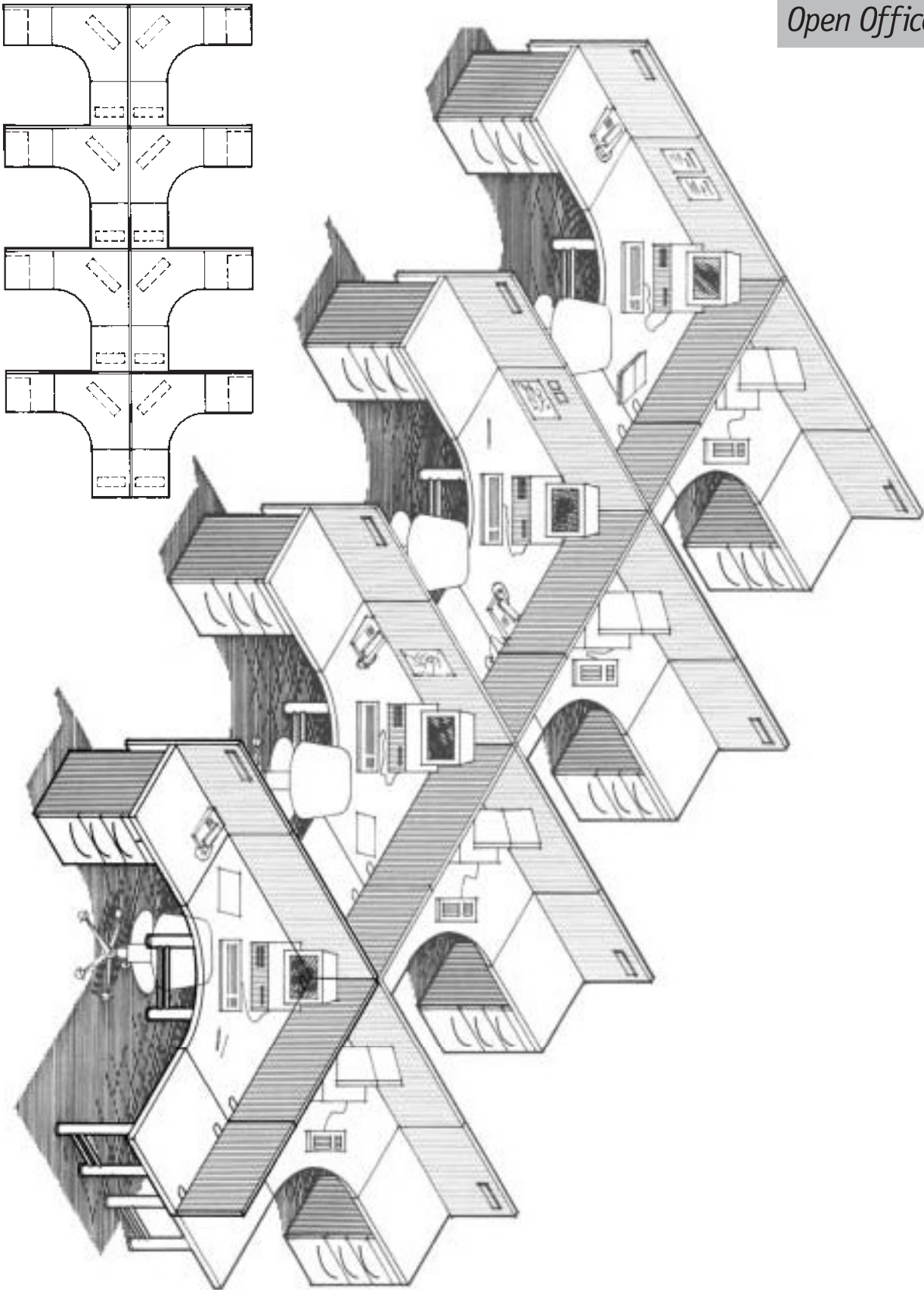

*Open Office*

5

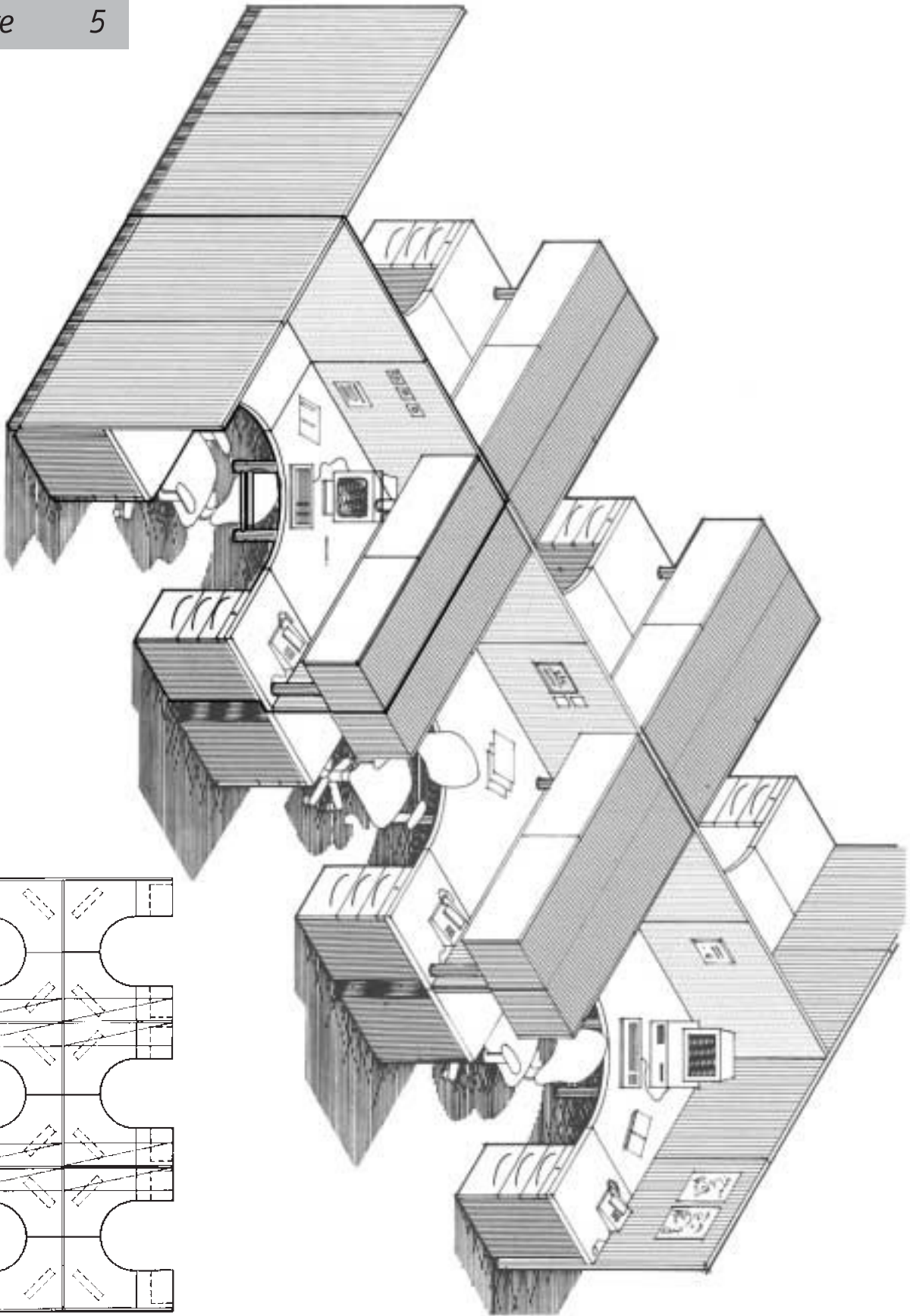

(APPROX. 288 SQUARE FEET)

\$ LIST (PER STATION)

(APPROX. 200 SQUARE FEET)

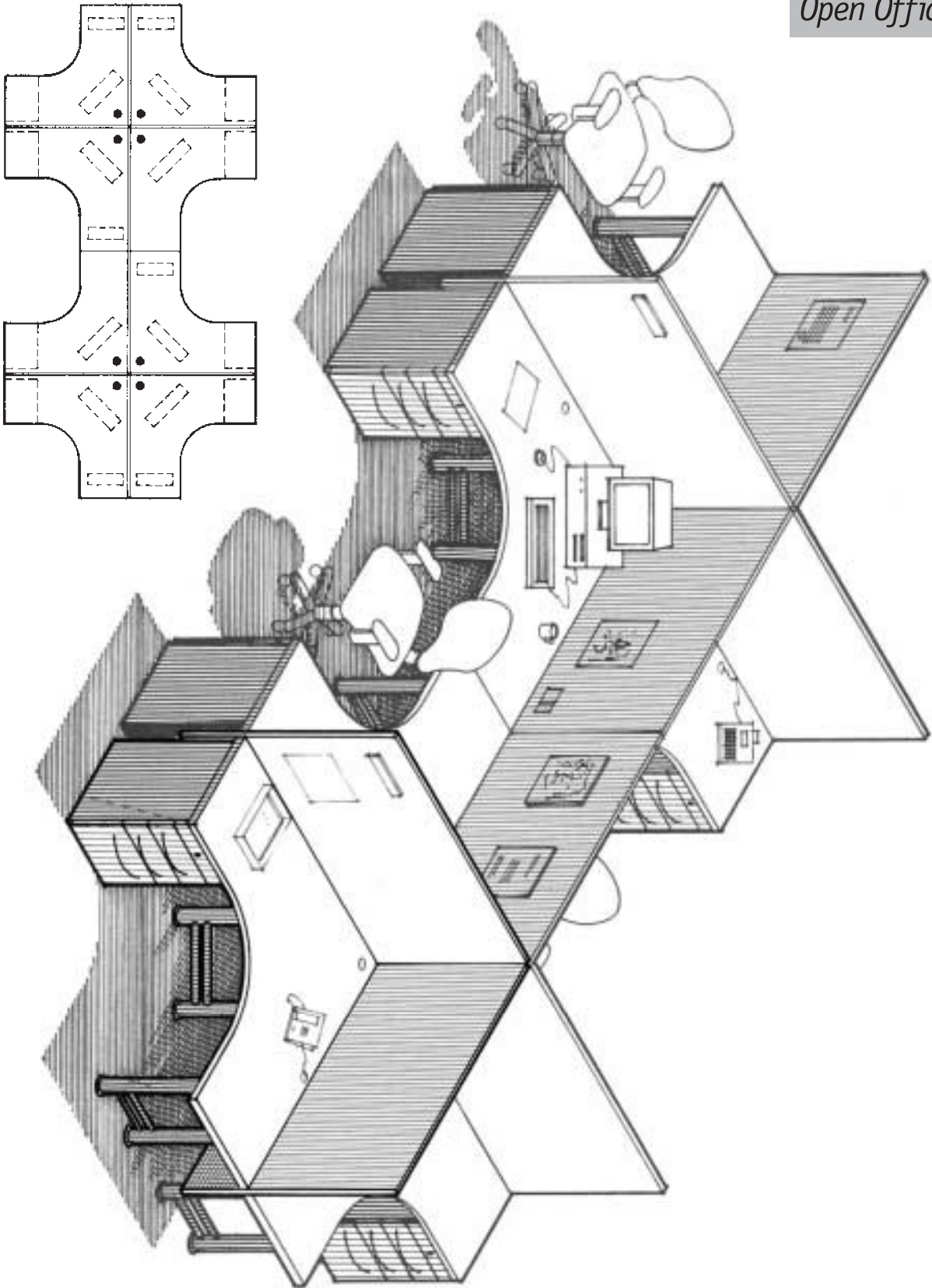



## Open Office

7

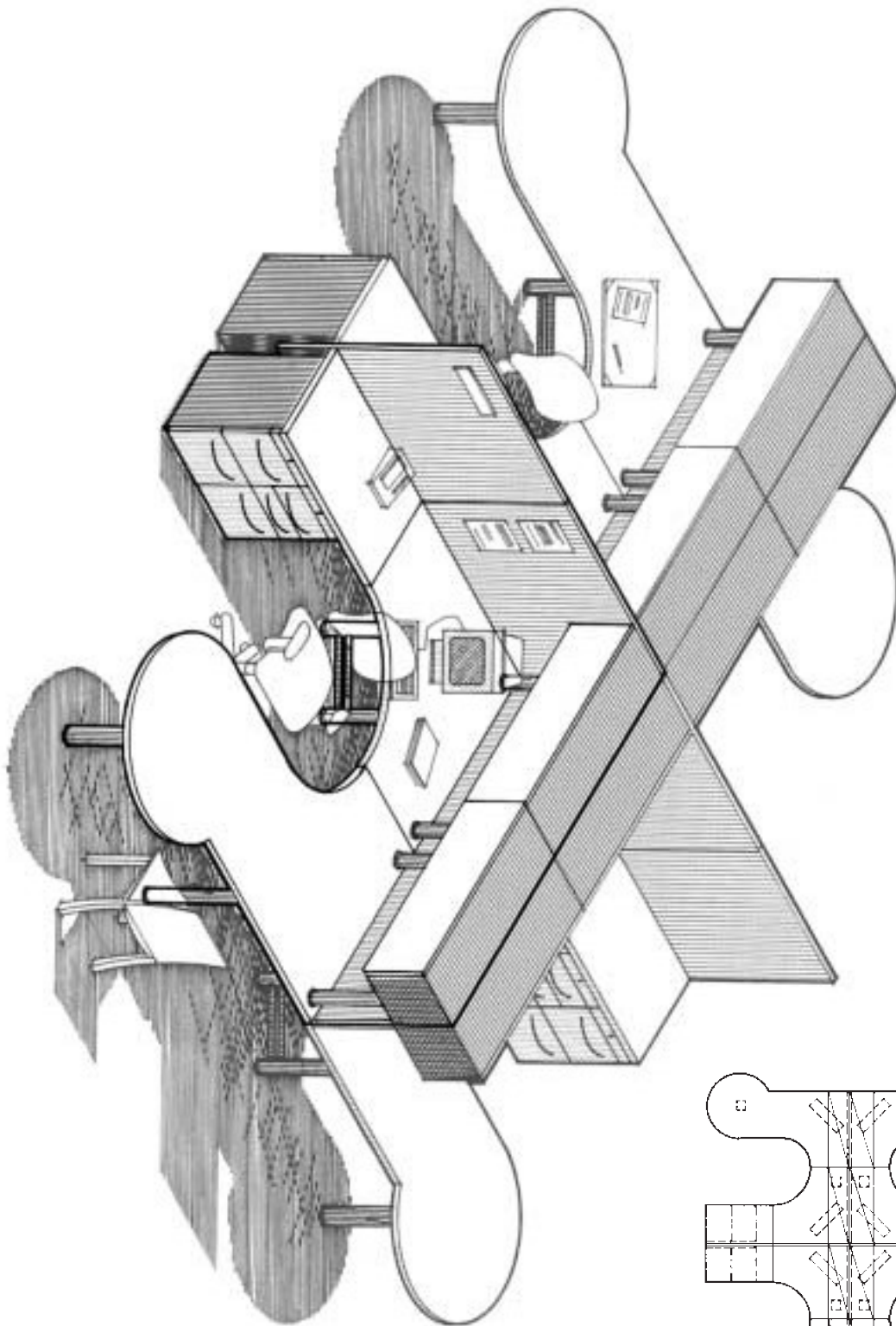

(APPROX. 270 SQUARE FEET)

\$ LIST (PER STATION)



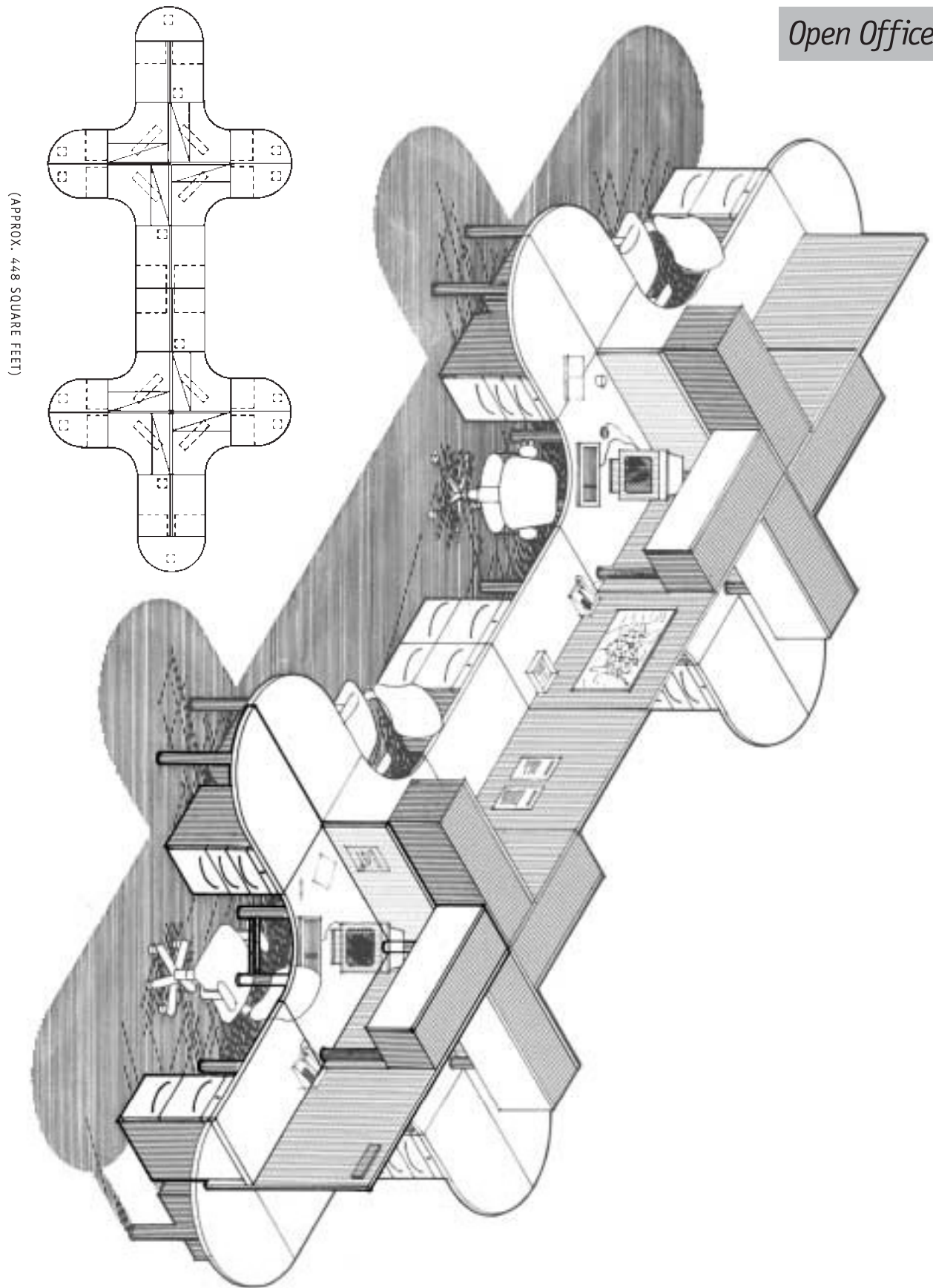

*Open Office*

9

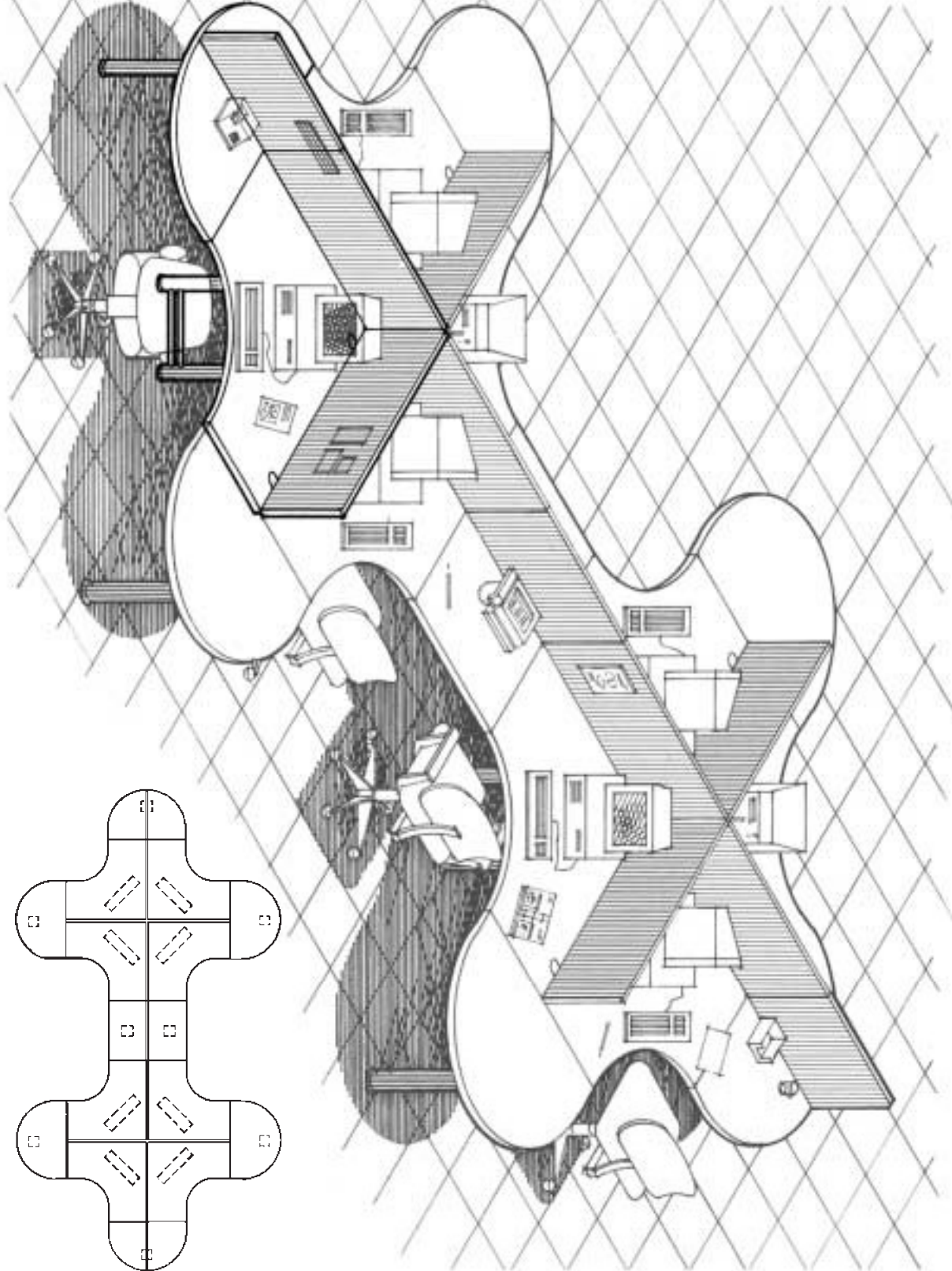

(APPROX. 72 SQUARE FEET)

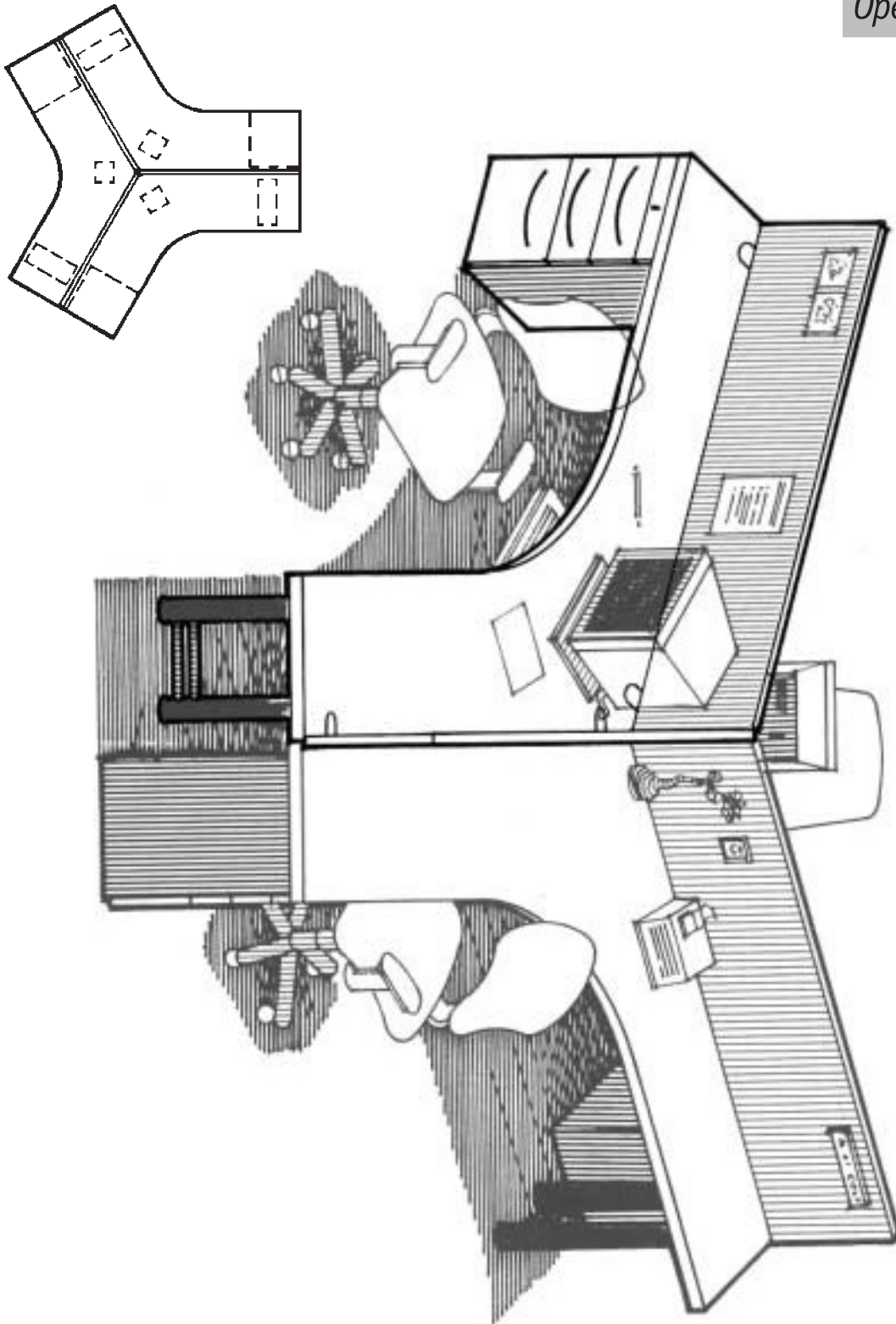

# Task Specific 1

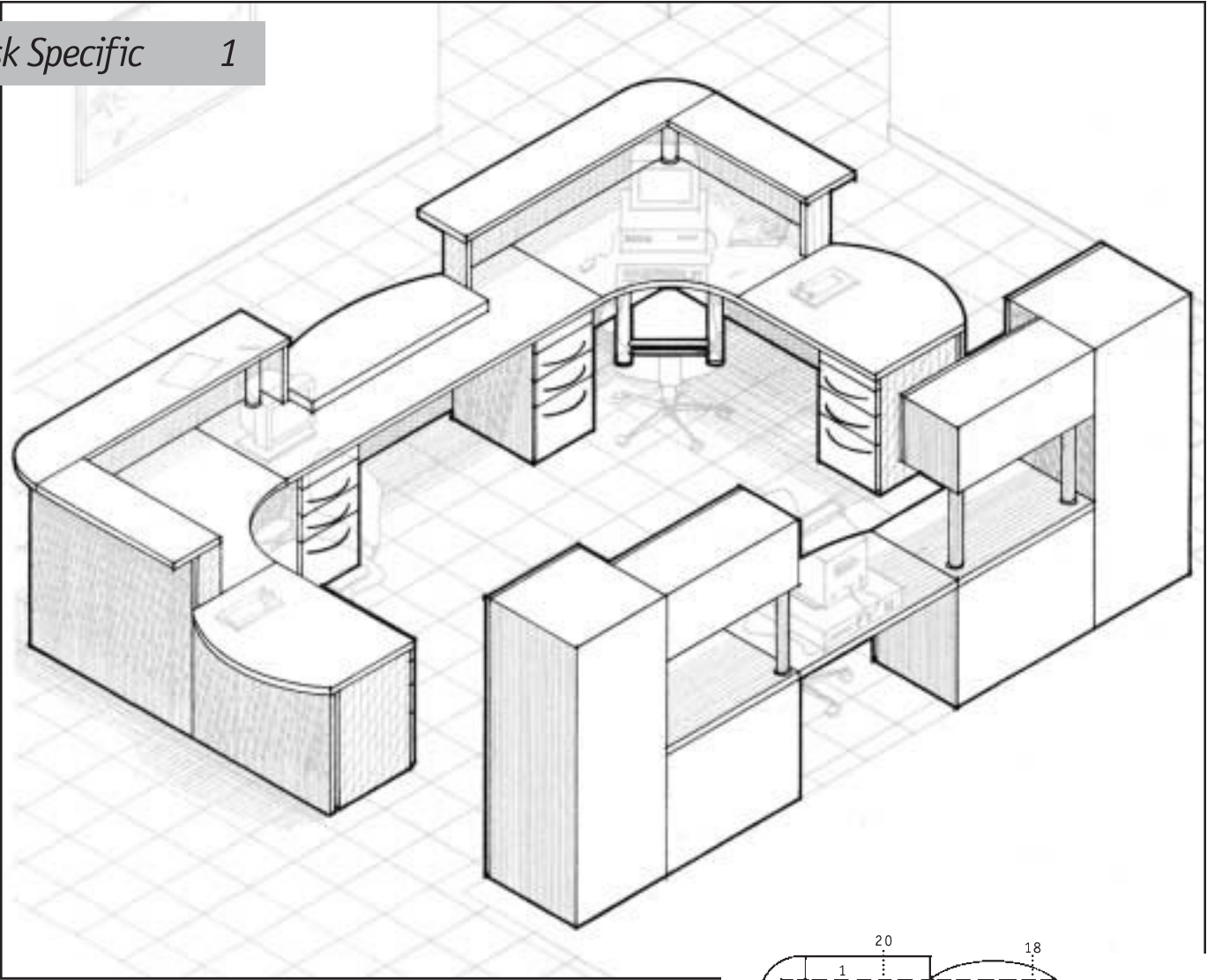

## NURSES STATION

Item	Model No.	Description	Size	Qty.
1	C1RW3612	Rectangular Worksurface	36 x 12 x 1 <sup>5</sup> / <sub>8</sub>	2
2	C1RW3024	Rectangular Worksurface	30 x 24 x 1 <sup>5</sup> / <sub>8</sub>	2
3	C1RW8424	Rectangular Worksurface	84 x 24 x 1 <sup>5</sup> / <sub>8</sub>	1
4	C1CI42/2424	Inside Radius Worksurface	42 x 42 x 1 <sup>5</sup> / <sub>8</sub>	2
5	C1SR-L-SPECIAL	Sgl End Radius Worksurface	66 x 12 x 1 <sup>5</sup> / <sub>8</sub>	1
6	C1SR-R-SPECIAL	Sgl End Radius Worksurface	66 x 12 x 1 <sup>5</sup> / <sub>8</sub>	1
7	C1BF4818	Bow Front Worksurface	48 x 18 x 1 <sup>5</sup> / <sub>8</sub>	1
8	C1BF3630	Bow Front Worksurface	36 x 30 x 1 <sup>5</sup> / <sub>8</sub>	2
9	C1BF4230	Bow Front Worksurface	42 x 30 x 1 <sup>5</sup> / <sub>8</sub>	1
10	C1RW4812	Rectangular Worksurface	48 x 12 x 1 <sup>5</sup> / <sub>8</sub>	1
11	C2BB22	Pedestal, B/B/F	15 <sup>3</sup> / <sub>4</sub> x 21 <sup>1</sup> / <sub>2</sub> x 27 <sup>1</sup> / <sub>2</sub>	4
12	C2LF302D	2 Drawer Lateral File	30 x 18 x 27 <sup>1</sup> / <sub>2</sub>	2
13	C3DL2327	Double Support Leg	23 x 3 x 27 <sup>1</sup> / <sub>2</sub>	2
14	C4UP11	Transaction Support Post	3" dia x 11	6
15	C4SF30	Upper Storage Cabinet, Flipper Door	30 x 15 x 16	2
16	C5WT242463	Wardrobe Tower	24 x 24 x 63	2
17	C5WA242263	Wardrobe Accessory	24 x 22 x 63	2
18	C6FM3626	Full Modesty Panel	36 x 1 <sup>1</sup> / <sub>4</sub> x 26 <sup>3</sup> / <sub>8</sub>	2
19	C6FM4826	Full Modesty Panel	48 x 1 <sup>1</sup> / <sub>4</sub> x 26 <sup>3</sup> / <sub>8</sub>	1
20	C6FM4240	Full Modesty Panel	42 x 1 <sup>1</sup> / <sub>4</sub> x 40 <sup>1</sup> / <sub>2</sub>	2
21	C6FM6040	Full Modesty Panel	60 x 1 <sup>1</sup> / <sub>4</sub> x 40 <sup>1</sup> / <sub>2</sub>	2

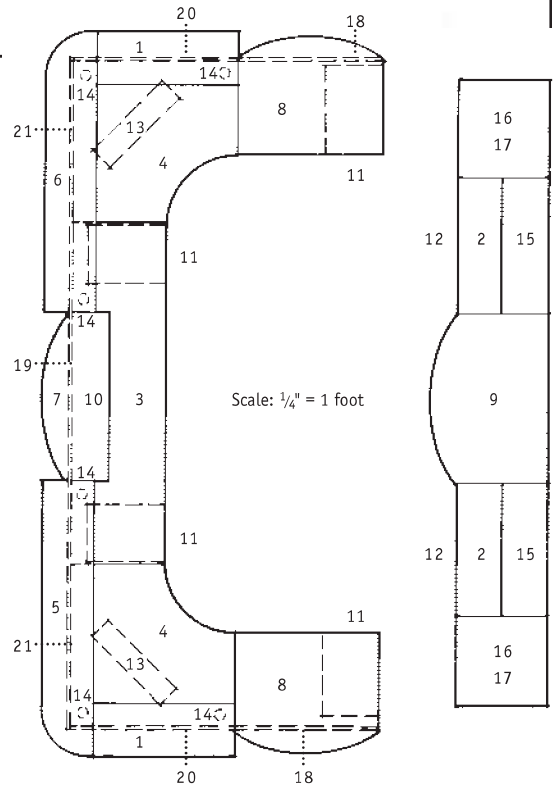



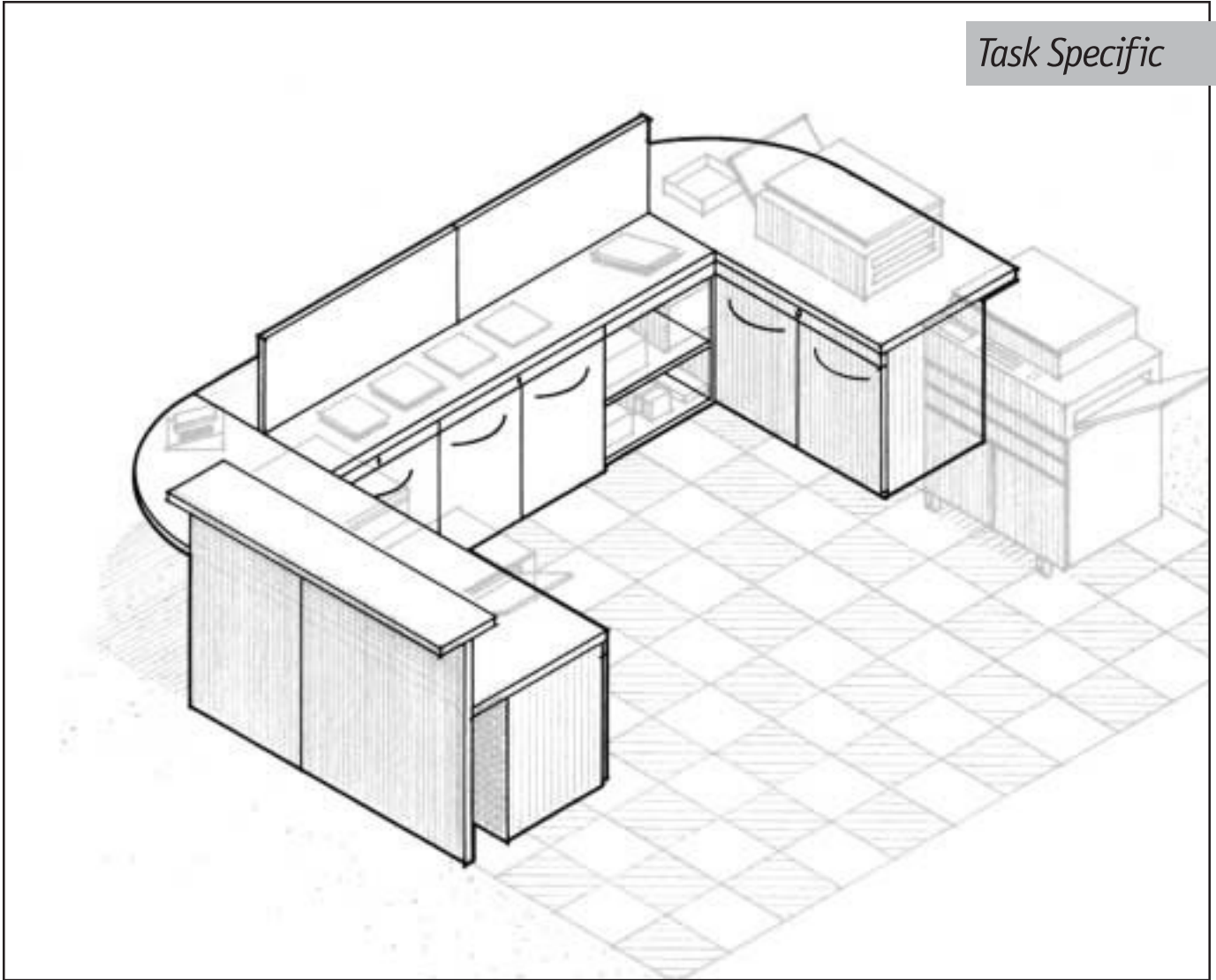

## MACHINE STATION

Item	Model No.	Description	Size	Qty.
1	C1RW8430	Rectangular Worksurface	84 x 30 x 1 <sup>5</sup> / <sub>8</sub>	1
2	C1SR9630L	Sgl End Radius Worksurface	96 x 30 x 1 <sup>5</sup> / <sub>8</sub>	1
3	C1SR6630R	Sgl End Radius Worksurface	66 x 30 x 1 <sup>5</sup> / <sub>8</sub>	1
4	C1RW6612	Rectangular Worksurface	66 x 12 x 1 <sup>5</sup> / <sub>8</sub>	1
5	C2LS3622D	Lower Storage Cabinet, 2 Doors	36 x 21 <sup>1</sup> / <sub>2</sub> x 27 <sup>1</sup> / <sub>2</sub>	2
6	C2LS24220	Lower Storage Cabinet, Open	24 x 21 <sup>1</sup> / <sub>2</sub> x 27 <sup>1</sup> / <sub>2</sub>	1
7	C2LS3022D	Lower Storage Cabinet, 2 Doors	30 x 21 <sup>1</sup> / <sub>2</sub> x 27 <sup>1</sup> / <sub>2</sub>	3
8	C4UP11	Transaction Support Top	2 <sup>1</sup> / <sub>2</sub> " dia x 11	2
9	C6FM3640	Full Modesty Panel	36 x 1 <sup>1</sup> / <sub>4</sub> x 40 <sup>1</sup> / <sub>2</sub>	1
10	C6FM3040	Full Modesty Panel	30 x 1 <sup>1</sup> / <sub>4</sub> x 40 <sup>1</sup> / <sub>2</sub>	1
11	C6PS4218	Surface Mounted Screen	42 x 1 <sup>1</sup> / <sub>4</sub> x 18	2

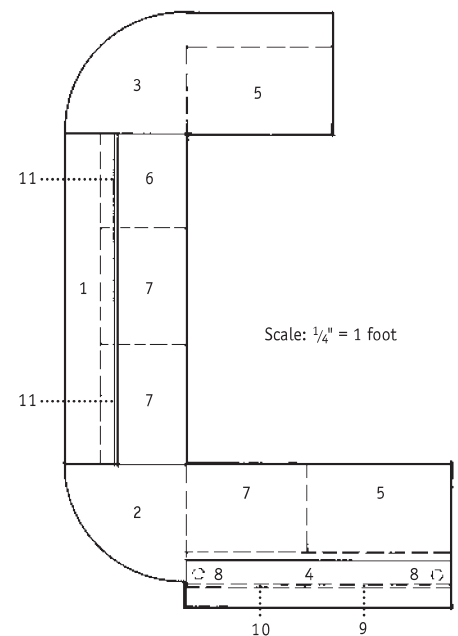

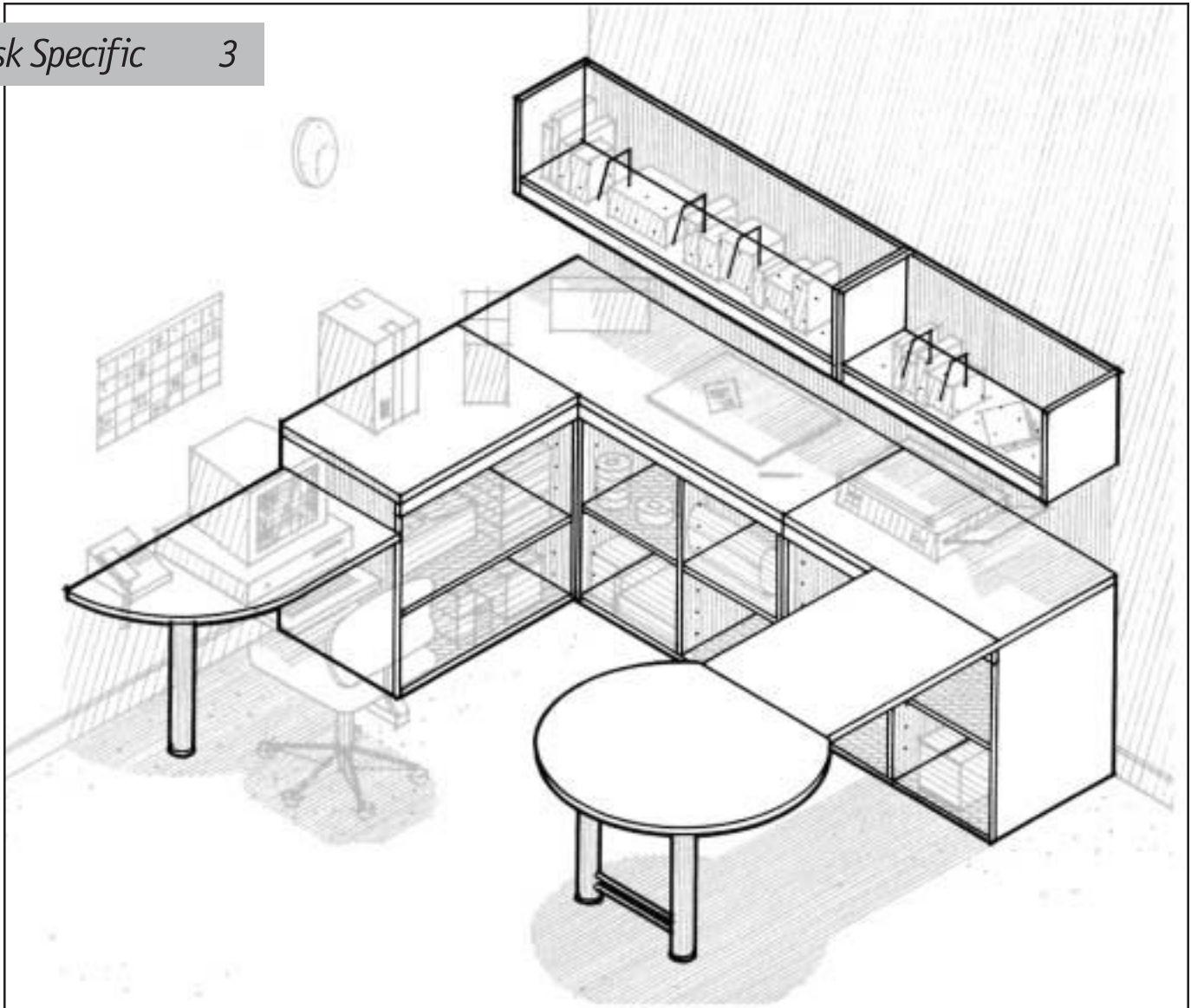

**Task Specific**     **3**

**SERVICE/MAILROOM**

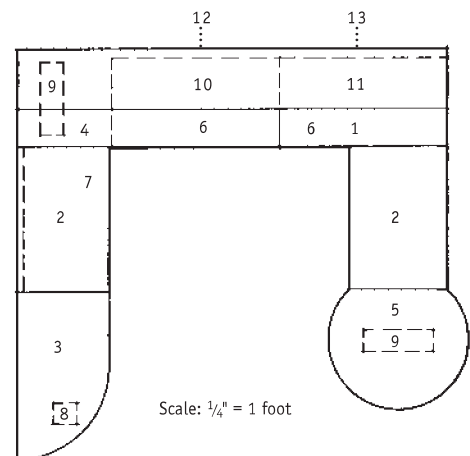
Item	Model No.	Description	Size	Qty.
1	C1RW4224	Rectangular Worksurface	42 x 24 x 1 $\frac{5}{8}$	1
2	C1RW3624	Rectangular Worksurface	36 x 24 x 1 $\frac{5}{8}$	2
3	C1SR4224L	Sgl End Radius Worksurface	42 x 24 x 1 $\frac{5}{8}$	1
4	C1RW6624	Rectangular Worksurface	66 x 24 x 1 $\frac{5}{8}$	1
5	C1FT36/24	Flat Tire Worksurface	36" dia x 1 $\frac{5}{8}$	1
6	C2MS42220	Middle Storage	42 x 21 $\frac{1}{2}$ x 34 $\frac{1}{2}$	2
7	C2MS36220	Middle Storage	36 x 21 $\frac{1}{2}$ x 34 $\frac{1}{2}$	1
8	C3SL3D27	Support Leg	3" dia x 27 $\frac{1}{2}$	1
9	C3DL1734	Double Support Leg	16 $\frac{1}{4}$ x 3 x 34 $\frac{1}{2}$	2
10	C4SS66W	Upper Storage Shelf	66 x 15 x 16	1
11	C4SS42W	Upper Storage Shelf	42 x 15 x 16	1
12	C4MT66	Wall Mount Track	66 x $\frac{1}{4}$ x 2 $\frac{3}{4}$	1
13	C4MT42	Wall Mount Track	42 x $\frac{1}{4}$ x 2 $\frac{3}{4}$	1

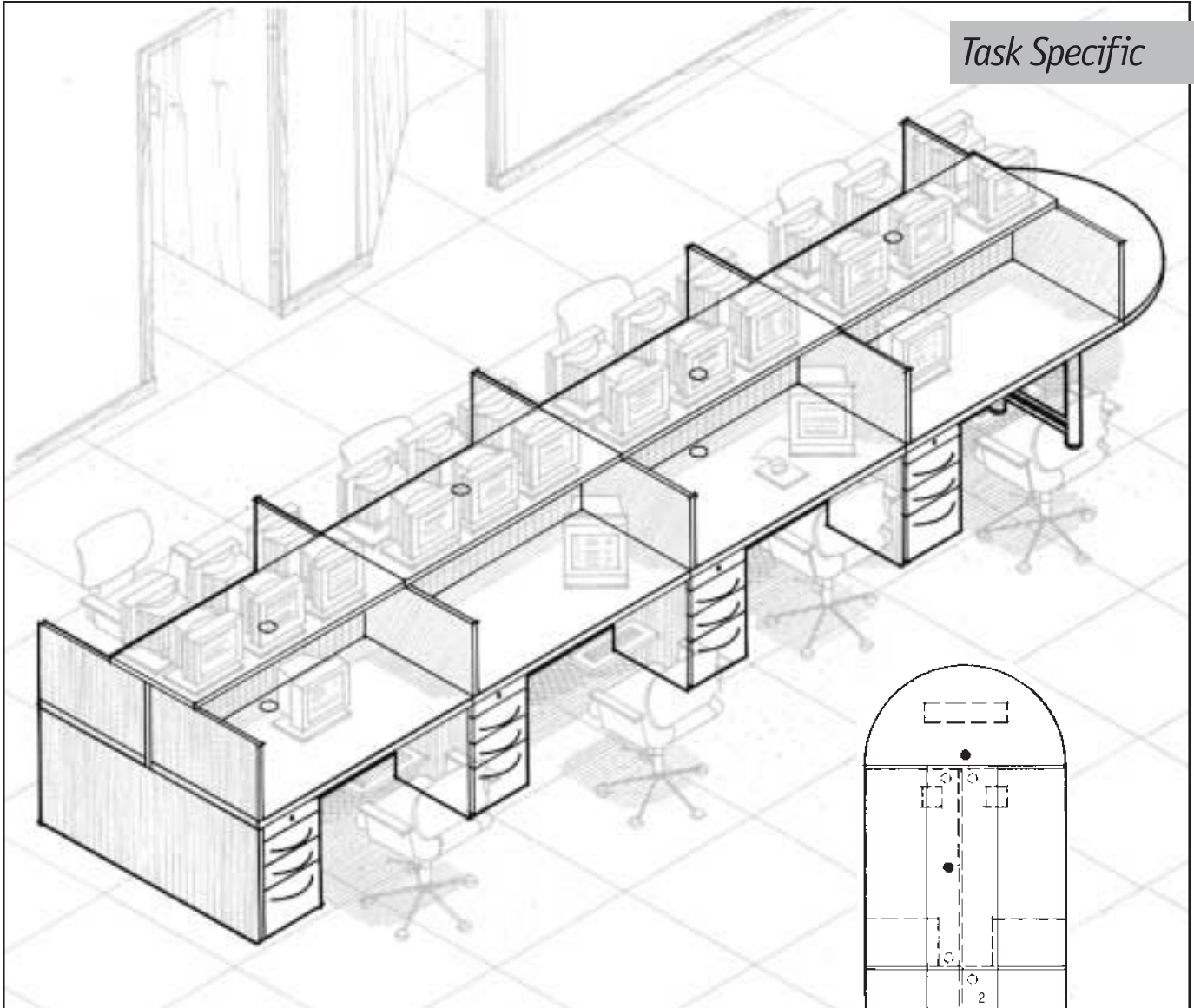

**TRADING DESK**

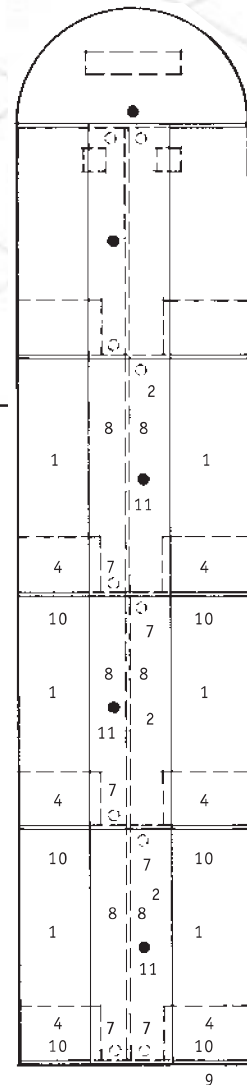
Item	Model No.	Description	Size	Qty.
1	C1RW6030	Rectangular Worksurface	60 x 30 x 1 <sup>5</sup> / <sub>8</sub>	8
2	C1RW6020	Rectangular Worksurface	60 x 20 x 1 <sup>5</sup> / <sub>8</sub>	4
3	C1HR60	Half Round Worksurface	60" dia x 1 <sup>5</sup> / <sub>8</sub>	1
4	C2BB22	Pedestal, B/B/F	15 <sup>3</sup> / <sub>4</sub> x 21 <sup>1</sup> / <sub>2</sub> x 27 <sup>1</sup> / <sub>2</sub>	8
5	C3DL2327	Double Support Leg	23 x 3 x 27 <sup>1</sup> / <sub>2</sub>	1
6	C3SL3D27	Support Leg	3" dia x 27 <sup>1</sup> / <sub>2</sub>	2
7	C4UP11	Transaction Support Post	3" dia x 11	10
8	C6TP6018	Tack Panel	60 x 3 <sup>3</sup> / <sub>4</sub> x 17 <sup>1</sup> / <sub>2</sub>	8
9	C6FM6026	Full Modesty Panel	60 x 1 <sup>1</sup> / <sub>4</sub> x 26 <sup>3</sup> / <sub>8</sub>	1
10	C6PS3018	Surface Mounted Screen	30 x 1 <sup>1</sup> / <sub>4</sub> x 18	10
11	C7TG50	Pass Through Grommet	2 <sup>1</sup> / <sub>2</sub> " dia	9



Scale: 1/4" = 1 foot

9

**\$ LIST (PER STATION)**

# Task Specific 5

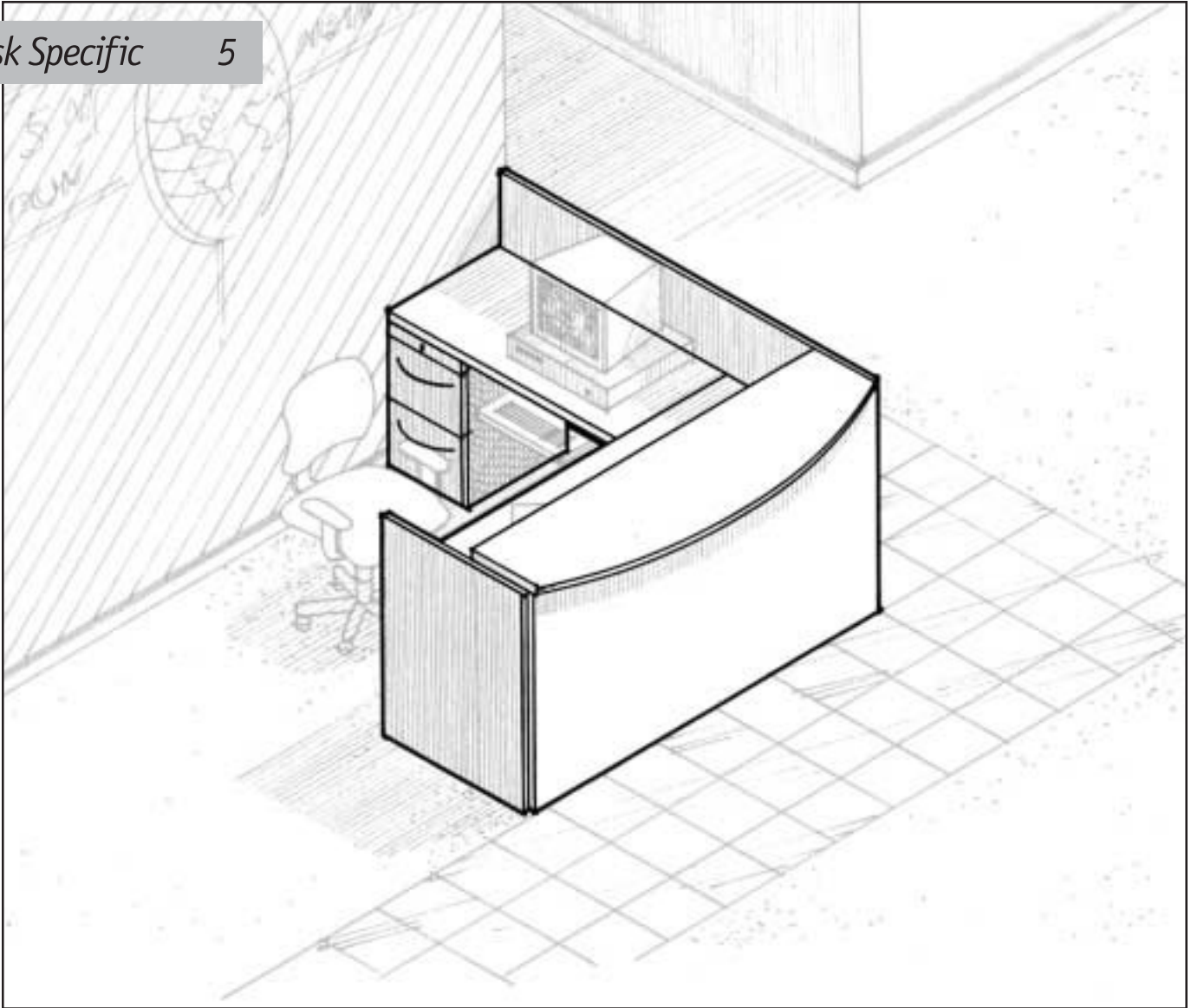

## RECEPTION DESK

Item	Model No.	Description	Size	Qty.
1	C1RW4824	Rectangular Worksurface	48 x 24 x 1 $\frac{5}{8}$	1
2	C1RW7230	Rectangular Worksurface	72 x 30 x 1 $\frac{5}{8}$	1
3	C1BF7218	Bow Front Worksurface	72 x 18 x 1 $\frac{5}{8}$	1
4	C2BB22	Pedestal, B/B/F	15 $\frac{3}{4}$ x 21 $\frac{1}{2}$ x 27 $\frac{1}{2}$	1
5	C2FF22	Pedestal, F/F	15 $\frac{3}{4}$ x 21 $\frac{1}{2}$ x 27 $\frac{1}{2}$	1
6	C3DL2327	Double Support Leg	16 $\frac{1}{4}$ x 3 x 27 $\frac{1}{2}$	1
7	C4UP11	Transaction Support Post	3" dia x 11	2
8	C6FM7840	Full Modesty Panel	78 x 1 $\frac{1}{4}$ x 40 $\frac{1}{2}$	1
9	C6FM3040	Full Modesty Panel	30 x 1 $\frac{1}{4}$ x 40 $\frac{1}{2}$	1
10	C6FM-SPECIAL	Full Modesty Panel	74 $\frac{1}{2}$ x 1 $\frac{1}{4}$ x 40 $\frac{1}{2}$	1

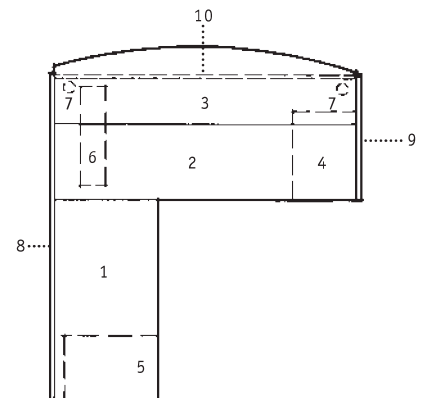

Scale:  $\frac{1}{4}$ " = 1 foot

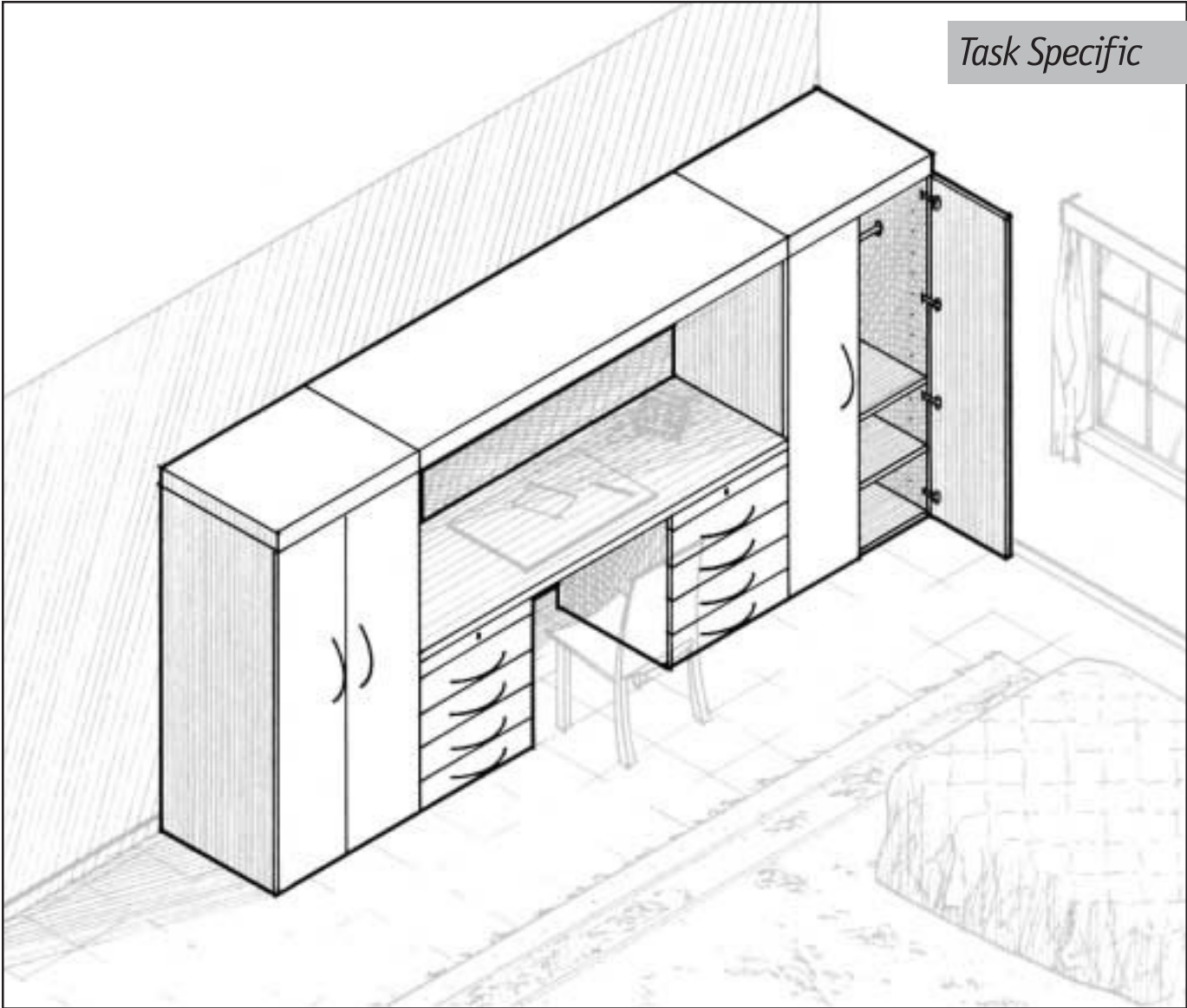

HEALTHCARE/DORMITORY

Item	Model No.	Description	Size	Qty.
1	C1RW7824	Rectangular Worksurface	78 x 24 x 1 <sup>5</sup> / <sub>8</sub>	1
2	C2LS24224D	Lower Storage, 4 Drawers	24 x 21 <sup>1</sup> / <sub>2</sub> x 27 <sup>1</sup> / <sub>2</sub>	2
3	C5WT302472	Wardrobe Tower	30 x 24 x 72	2
4	C5TT3024	Tower Tops	30 x 24 x 3	2
5	C5TB7824	Tower Bridge	78 x 24 x 3	1
6	C5WA242272	Wardrobe Accessory	24 x 22 x 72	2

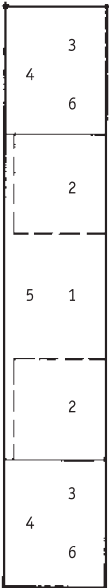

Scale: 1/4" = 1 foot

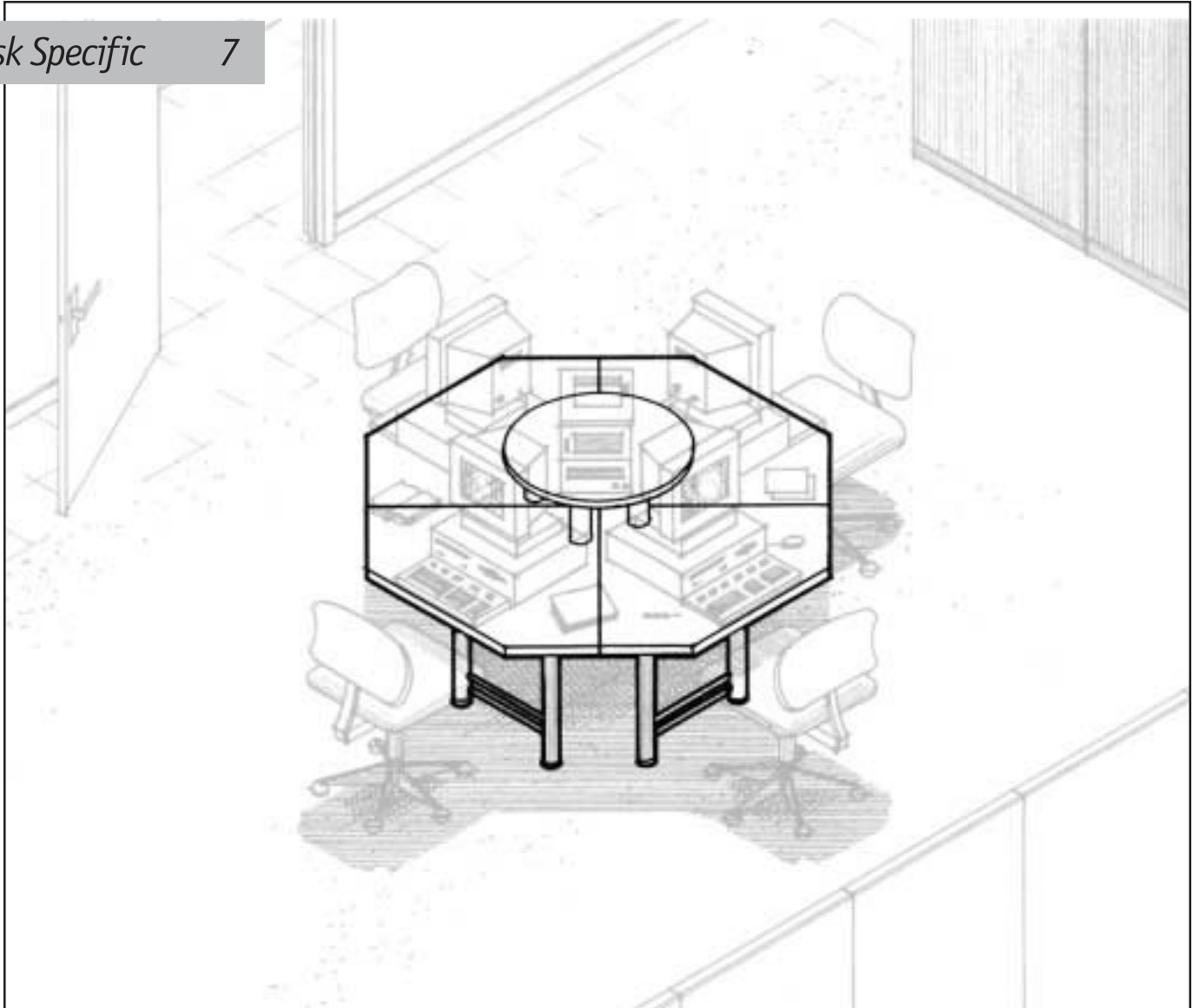

**Task Specific**     **7**

**COMPUTER CENTER**

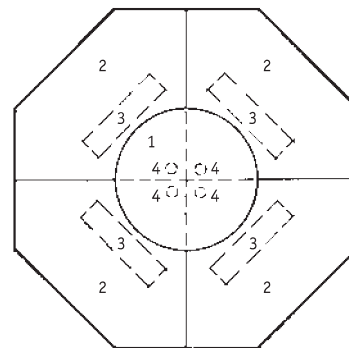
Item	Model No.	Description	Size	Qty.
1	C1FR36	Full Round Worksurface	36" dia x 1 $\frac{5}{8}$ "	1
2	C1CW-SPECIAL	Corner Worksurface	42 x 42 x 1 $\frac{5}{8}$ "	4
3	C3DL2327	Double Support Leg	23 x 3 x 27 $\frac{1}{2}$ "	4
4	C4UP11	Transaction Support Post	3" dia x 11"	4

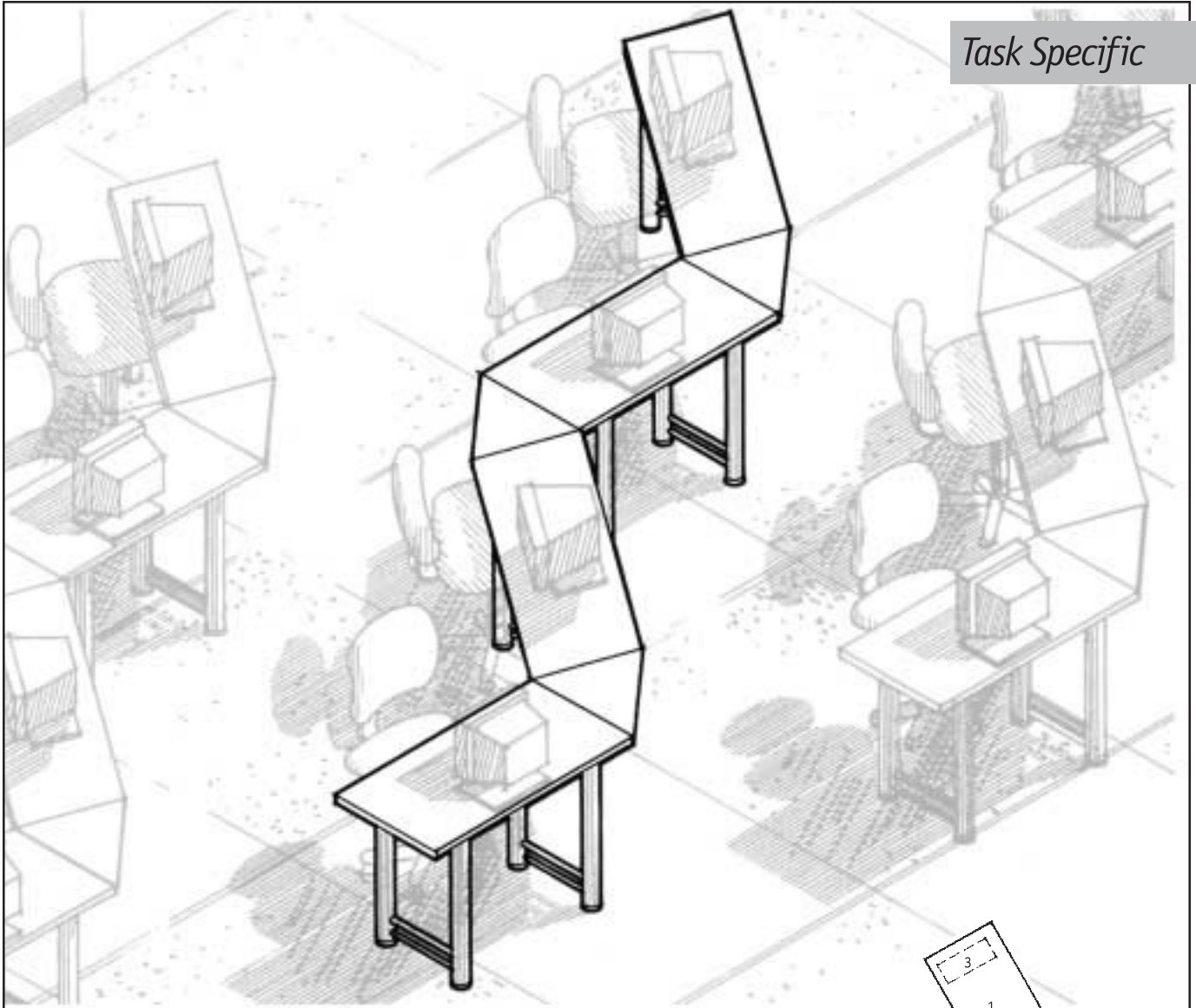

 Scale:  $\frac{1}{4}$ " = 1 foot



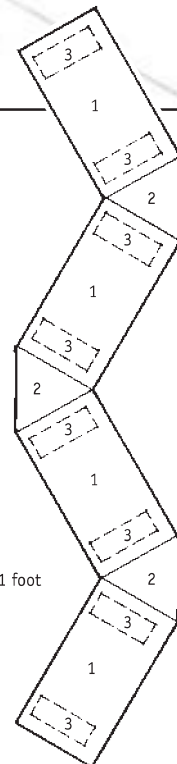

## CLASSROOM

Item	Model No.	Description	Size	Qty.
1	C1RW4220	Rectangular Worksurface	42 x 20 x 1 <sup>5</sup> / <sub>8</sub>	4
2	C1TW20	Equilateral Triangular Worksurface	20 x 20 x 1 <sup>5</sup> / <sub>8</sub>	3
3	C3DL1727	Double Support Leg	16 <sup>1</sup> / <sub>4</sub> x 3 x 27 <sup>1</sup> / <sub>2</sub>	8

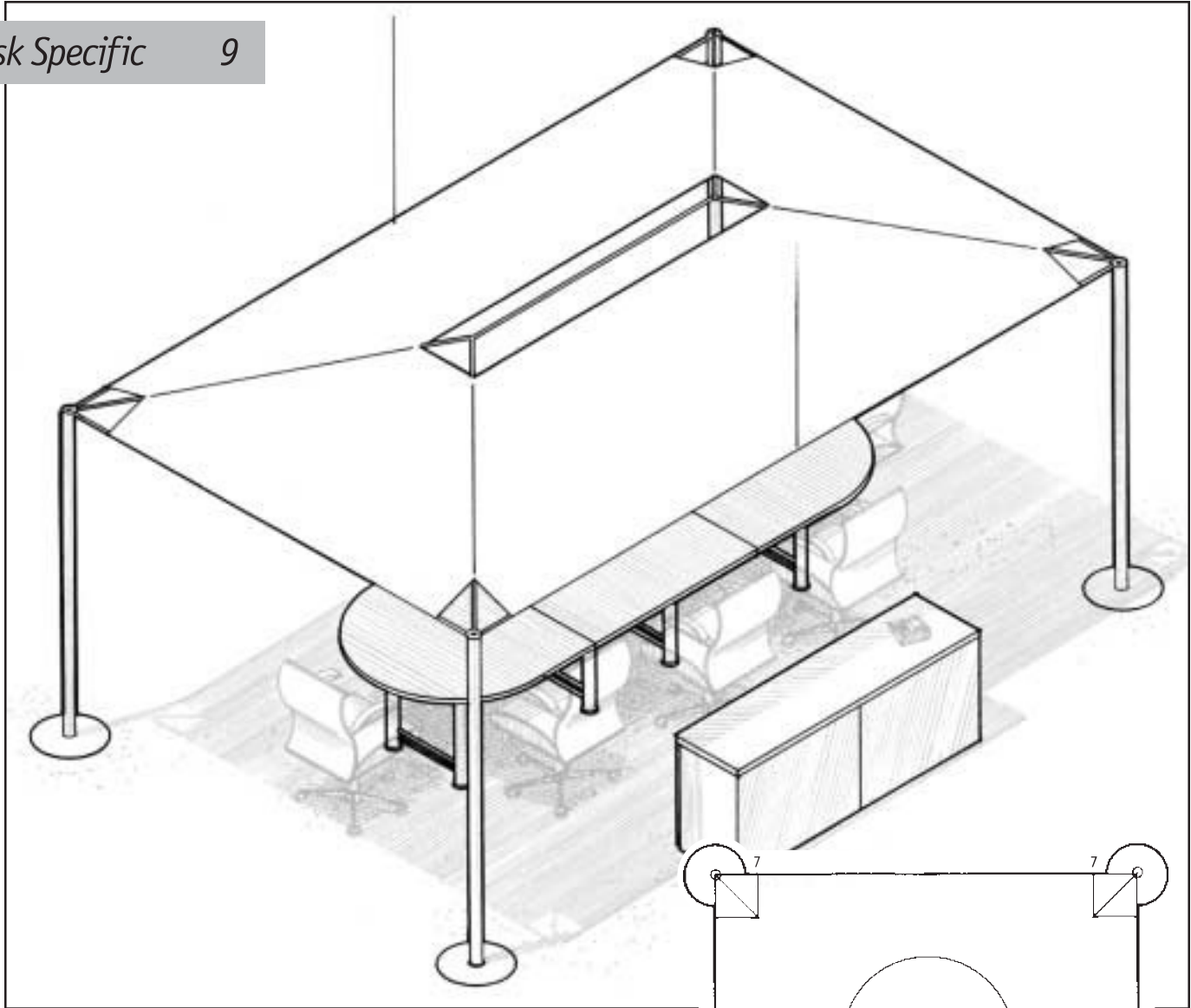

Scale: 1/4" = 1 foot

**Task Specific**     **9**

**CONFERENCE AREA**

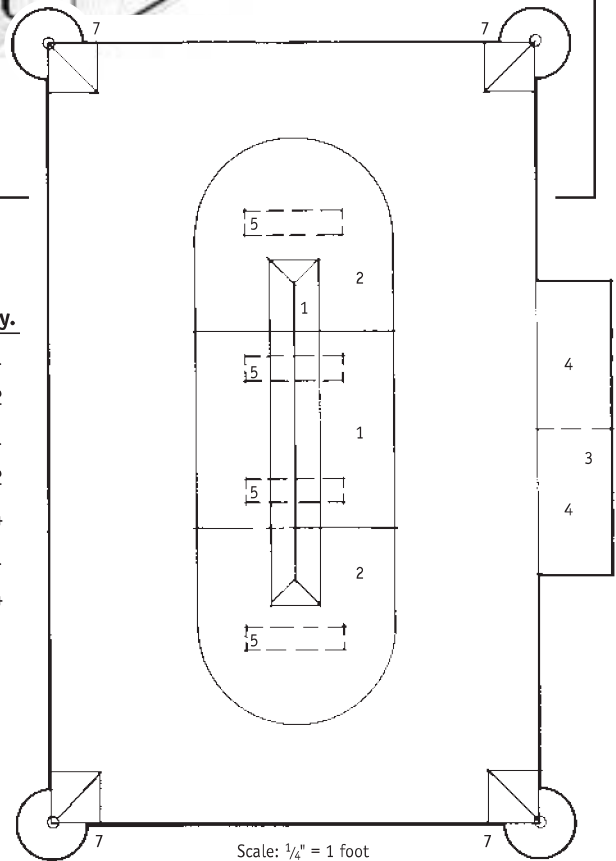
Item	Model No.	Description	Size	Qty.
1	C1SW48	Square Worksurface	48 x 48 x 1 $\frac{5}{8}$	1
2	C1SP4848	Spanner Worksurface	48 x 48 x 1 $\frac{5}{8}$	2
3	C1RW7218	Rectangular Worksurface	72 x 18 x 1 $\frac{5}{8}$	1
4	C2LS3618D	Lower Storage Cabinet w/Doors	36 x 18 x 27 $\frac{1}{2}$	2
5	C3DL2327	Double Support Leg	23 x 3 x 27 $\frac{1}{2}$	4
6	C6TA1216	Conferencing Tent	144 x 192 x 18	1
7	C6TS84	Tent Support	22" dia x 84	4

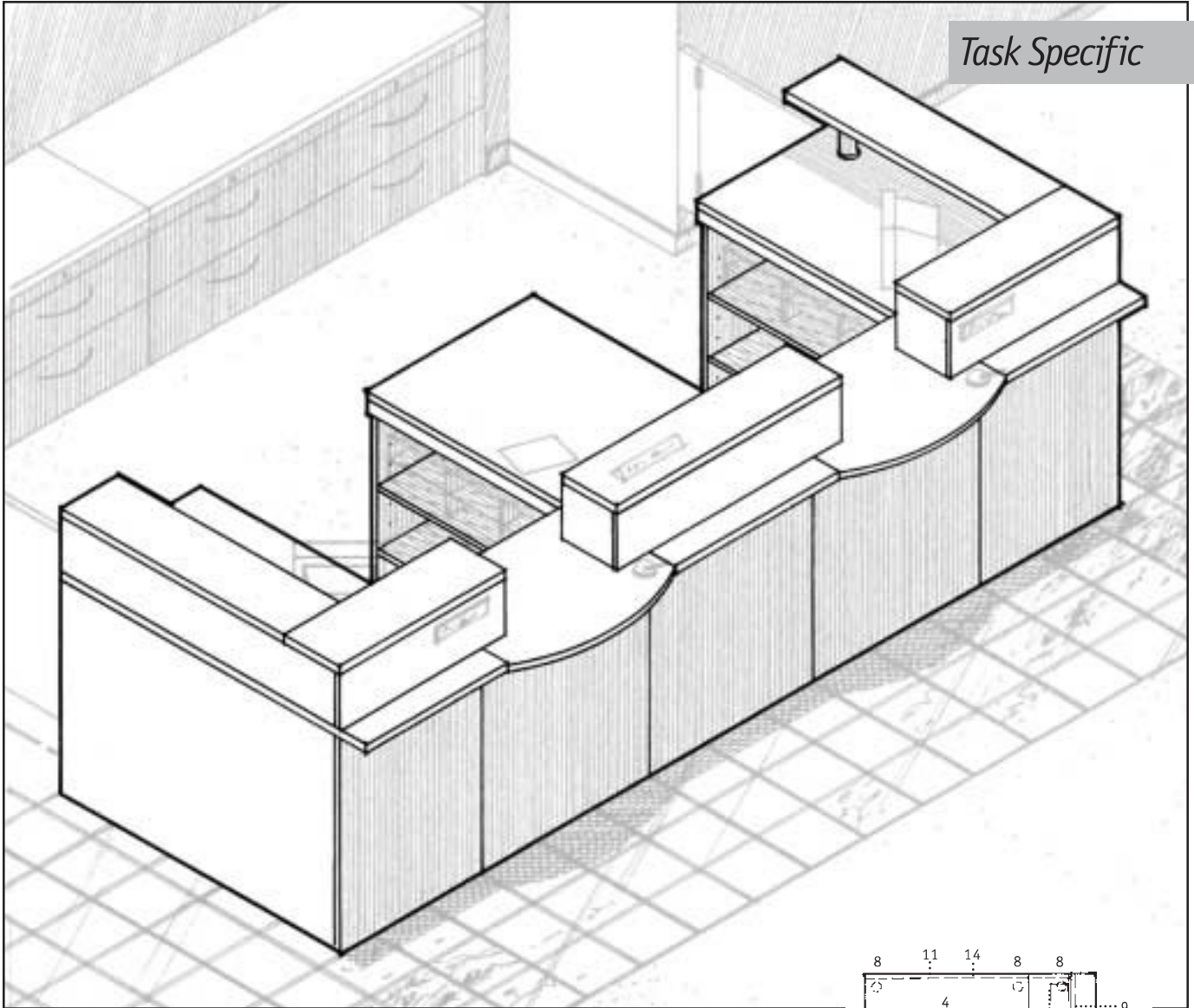
**\$ LIST\***
*\*Price does not include tent. Contact factory for custom quote.*

**TELLER LINE**

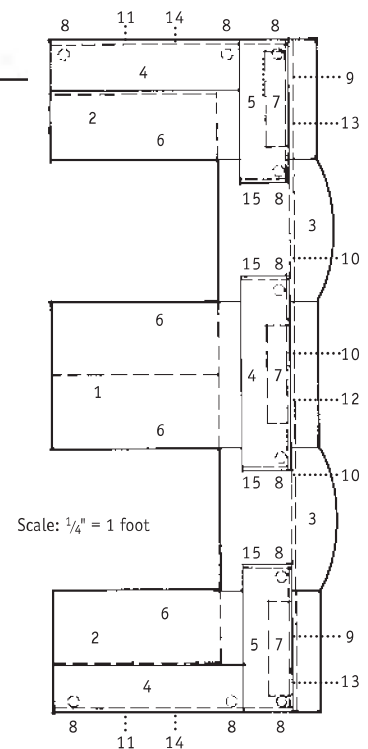
Item	Model No.	Description	Size	Qty.
1	C1RW6636	Rectangular Worksurface	66 x 36 x 1 $\frac{5}{8}$	1
2	C1RW6630	Rectangular Worksurface	66 x 30 x 1 $\frac{5}{8}$	1
3	C1BF3630	Bow Front Worksurface	36 x 30 x 1 $\frac{5}{8}$	1
4	C1RW4812	Rectangular Worksurface	48 x 12 x 1 $\frac{5}{8}$	1
5	C1RW3612	Rectangular Worksurface	36 x 12 x 1 $\frac{5}{8}$	1
6	C2HS42180	High Storage, Open	42 x 18 x 40 $\frac{1}{2}$	1
7	C3DL2340	Double Support Leg	23 x 3 x 40 $\frac{1}{2}$	1
8	C4UP11	Transaction Support Post	3" dia x 11	1
9	C6FM3040	Full Modesty Panel	30 x 1 $\frac{1}{4}$ x 40 $\frac{1}{2}$	1
10	C6FM3640	Full Modesty Panel	36 x 1 $\frac{1}{4}$ x 40 $\frac{1}{2}$	1
11	C6FM6040	Full Modesty Panel	60 x 1 $\frac{1}{4}$ x 40 $\frac{1}{2}$	1
12	C6MP-SPECIAL	Modesty Panel	48 x 1 $\frac{1}{4}$ x 11	1
13	C6MP-SPECIAL	Modesty Panel	36 x 1 $\frac{1}{4}$ x 11	1
14	C6MP-SPECIAL	Modesty Panel	58 $\frac{3}{4}$ x 1 $\frac{1}{4}$ x 11	1





HLF Furniture, Inc.

44001 Van Born Road Belleville, MI 48111

734-699-7100 Fax 734-697-3008